

Accord

Linee parallele e montaggio semplificato in totale armonia

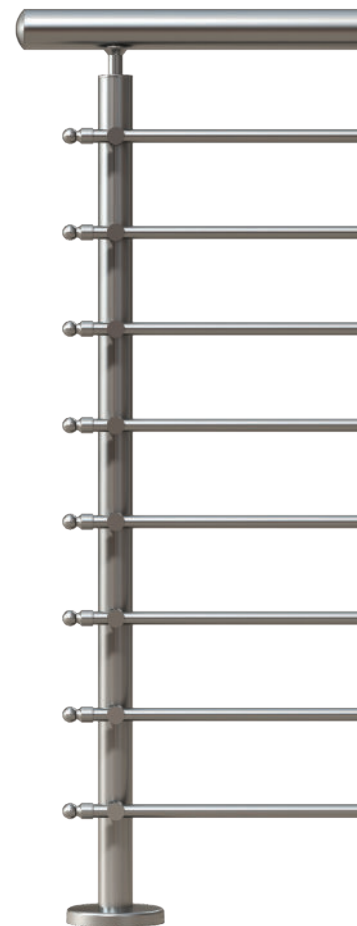



Accessori appositamente progettati, consentono l'applicazione del design Accord a qualsiasi tipo di ringhiera.



4116

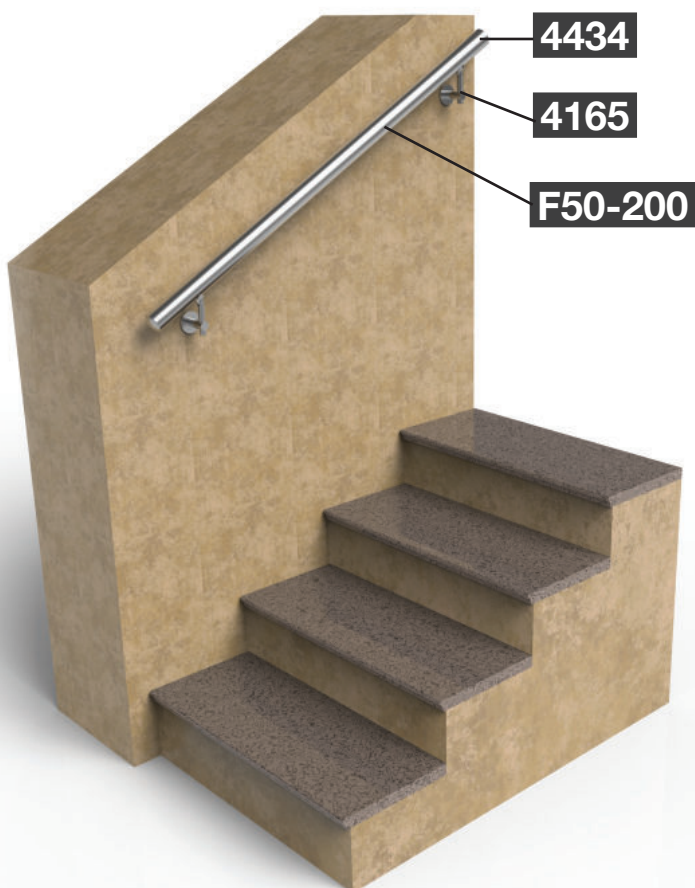

4434

4165

F50-200



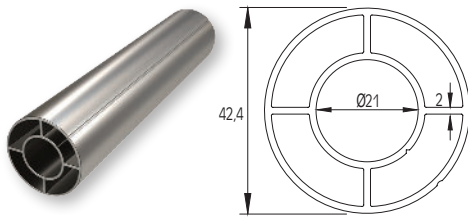

Colonna Ø42
Support column Ø42

Codice / Code	F50-100
Lunghezza / Length	5,8 m

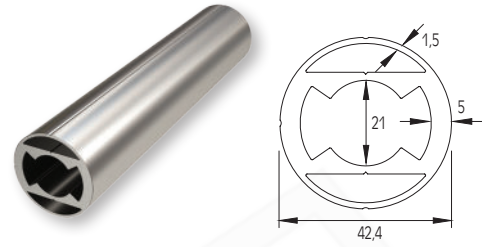

Colonna rinforzata Ø42
Reinforced column Ø42

Codice / Code	F50-107
Lunghezza / Length	5,8 m

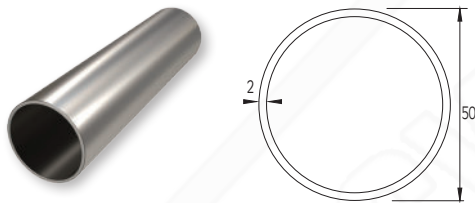

Corrimano Ø50
Handrail Ø50

Codice / Code	F50-200
Lunghezza / Length	5,8 m

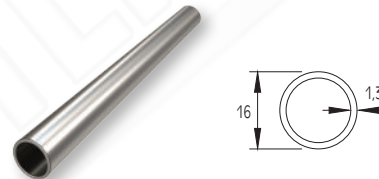

Profilo Ø16x1.3
Profile Ø16X1.3

Codice / Code	F50-300
Lunghezza / Length	5,8 m

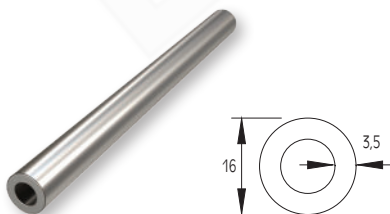

Profilo Ø16x3.5
Profile Ø16X3.5

Codice / Code	F50-301
Lunghezza / Length	5,8 m

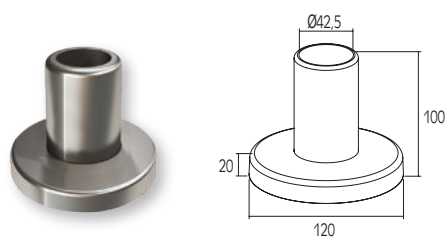

Piede per colonna Ø42
External support foot for Ø42 column

Codice / Code **4112**

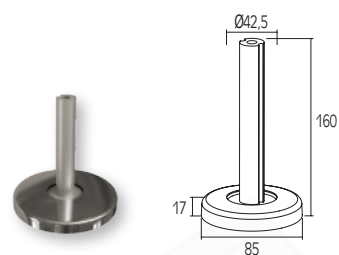

Piede per colonna Ø42
Support foot for Ø42 column

Codice / Code **4115**

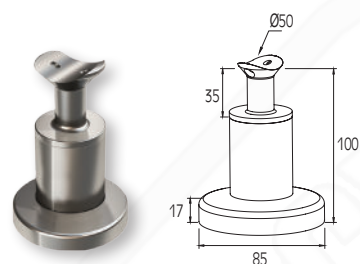

Supporto per corrimano F50-200
Support for F50-200 railtop

Codice / Code **4116**

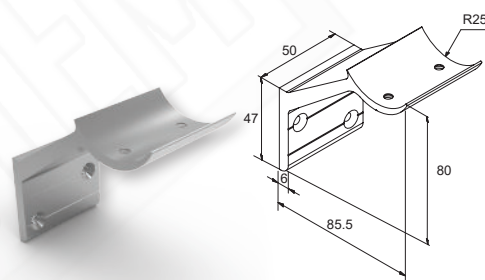

Supporto a parete per corrimano F50-200
Fixed wall support for F50-200 handrail

Codice / Code **4134**

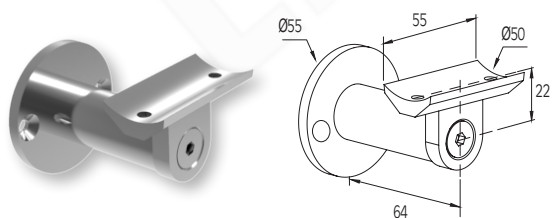

Supporto a muro per corrimano F50-200
Wall support for F50-200 handrail

Codice / Code **4140**

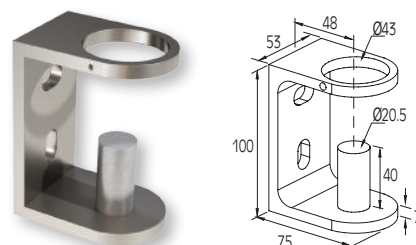

Supporto per fissaggio frontale per colonne
F50-100/103
External support for F50-100/103 columns

Codice / Code **4143**

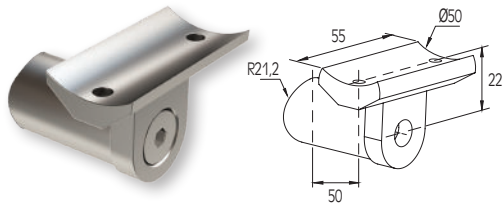

Supporto esterno per corrimano Ø50-colonna Ø42
External support for handrail Ø50-column Ø42

Codice / Code **4169B**

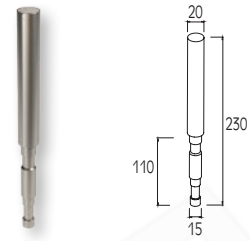

Supporto a pavimento per colonna F50-102
Infloor support for F50-102 column

Codice / Code **4188**



Supporto a pavimento per colonna F50-102 (400mm)
Infloor support for F50-102 column

Codice / Code **4188-A**

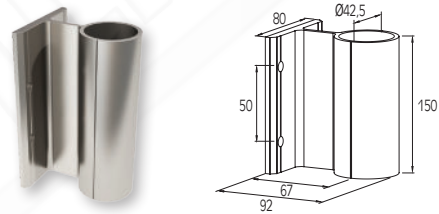

Supporto per fissaggio frontale per colonna Ø42
External support for column Ø42

Codice / Code **4194**

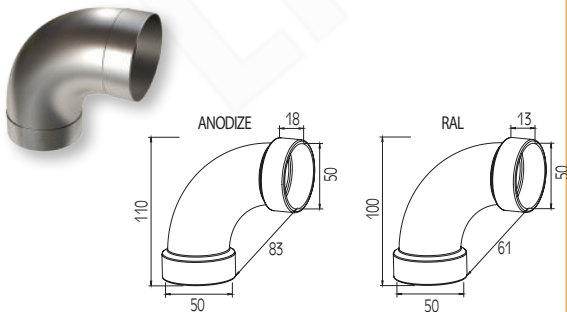

Connettore 90° per corrimano Ø50
Connector 90° for handrail Ø50

Codice / Code **4219**

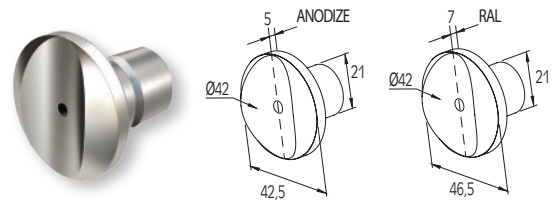

Connettore colonna-colonna F50-100
Connector for column with column F50-100

Codice / Code **4224**

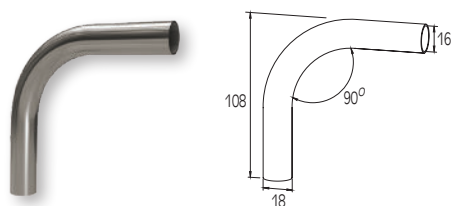

Connettore 90° con profilo Ø16
Connector 90° for profile Ø16

Codice / Code **4228**

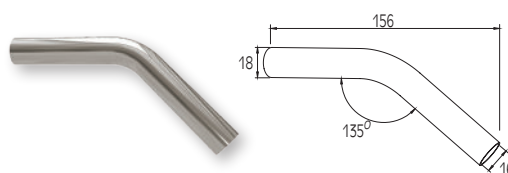

Connettore 135° con profilo Ø16
Connector 135° for profile Ø16

Codice / Code **4229**

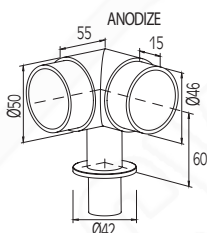

Connettore 90° per corrimano Ø50
Connector 90° for handrail Ø50

Codice / Code **4231**

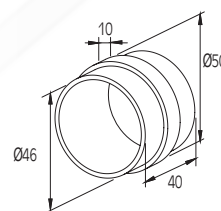

Connettore per corrimano Ø50 (interno)
Connector for handrail Ø50 (internal)

Codice / Code **4241**

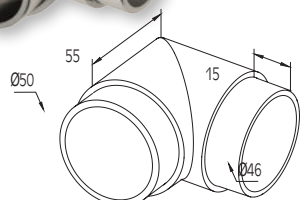

Connettore 90° per corrimano Ø50
Connector 90° for handrail Ø50

Codice / Code **4256**

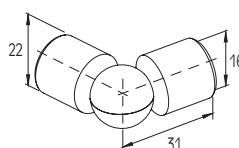

Connettore ad angolo regolabile per
profilo Ø16
Adjustable angle connector
for profile Ø16

Codice / Code **4302**

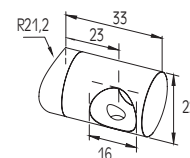

Connettore per F50-100
con profilo Ø16
Connector for F50-100 column
with guide Ø16

Codice / Code **4312**

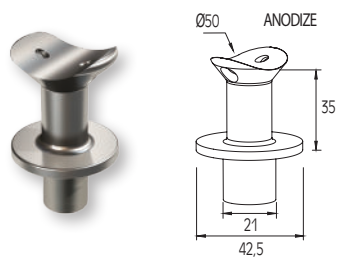

Connettore per corrimano Ø50 con colonna Ø42
Connector for handrail Ø50 with column Ø42

Codice / Code **4314**

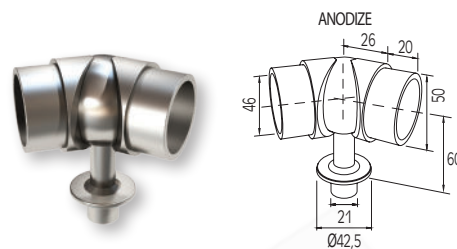

Connettore ad angolo regolabile per corrimano Ø50 -
colonna Ø42
Adjustable corner railtop connector

Codice / Code **4319**

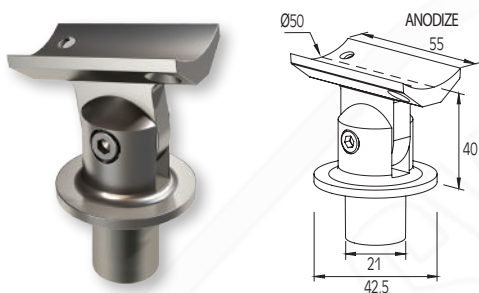

connettore per corrimano Ø50-colonna Ø42 (scala)
Connector for handrail Ø50
with column Ø42 (stairs)

Codice / Code **4316**

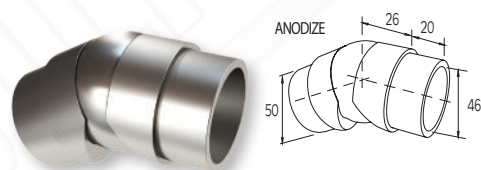

Connettore ad angolo regolabile per corrimano Ø50
Adjustable corner connector for column Ø50

Codice / Code **4329**

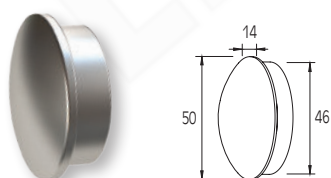

Tappo terminale per F50-200
End cap for F50-200 handrail

Codice / Code **4434**



Tappo terminale per F50-301
End cap for F50-301 profile

Codice / Code **4435**

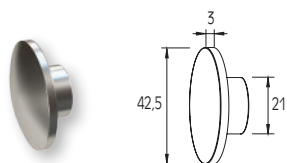

Tappo terminale per F50-100
End cap for F50-100 column

Codice / Code **4436**

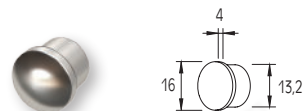

Tappo terminale per F50-300
End cap for F50-300 profile

Codice / Code **4438**

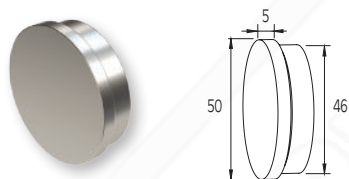

Tappo terminale per F50-200 (piatto)
End cap for F50-200 handrail (flat)

Codice / Code **4453**

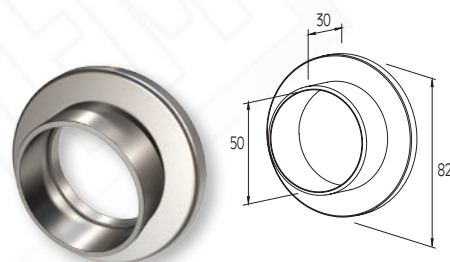

Fissaggio a parete per corrimano Ø50 con cover
Wall cover for handrail Ø50 with cap

Codice / Code **4509Z**

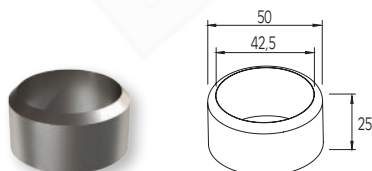

Cover per colonna Ø42
Wall cover for column Ø42

Codice / Code **4510**

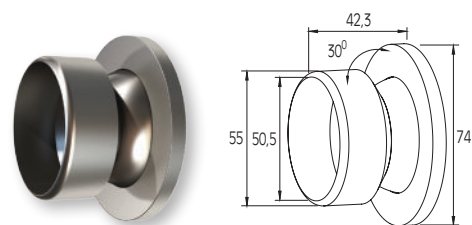

Fissaggio a parete ad angolo regolabile per corrimano
Ø50 con cover
Wall cover for handrail Ø50 with cap

Codice / Code **4518**



- In proporzione 1:1
- Tempo di azione 7-8 minuti
- Tempo di inizio incollaggio 15-18 minuti
- Tempo di completo incollaggio 3-6 ore

- In proportion 1:1
- Working time 7-8 min
- Initial welding time 15-18 min
- Complete welding time 3-6 hours

Collante bicomponente 50 ml
Glue 50 ml

Codice / Code **6K9450**



Beccuccio mixer per collante bicomponente
Glue mixer accessory

Codice / Code **6KA100**



Pistola per applicazione colla bicomponente
Glue application pistol

Codice / Code **6KA200**

