

Horizon FRAME

Un vetro incassato tra un corrimano superiore e una guida inferiore che si sviluppa in orizzontale creando l'effetto di un nastro continuo per il tuo balcone. Vista illimitata e design moderno in assoluta armonia.

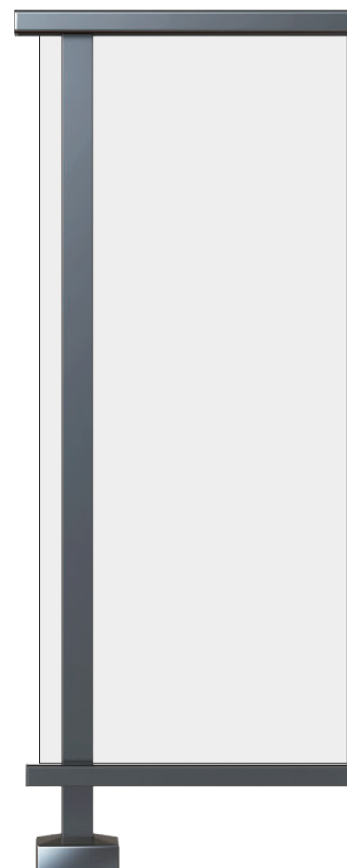

Horizon XFRAME

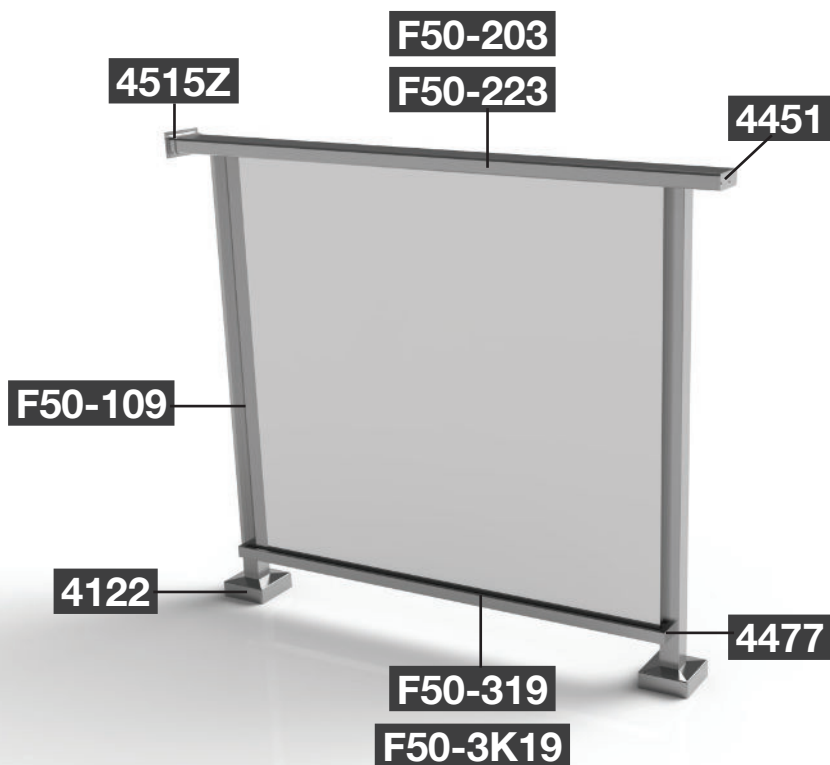
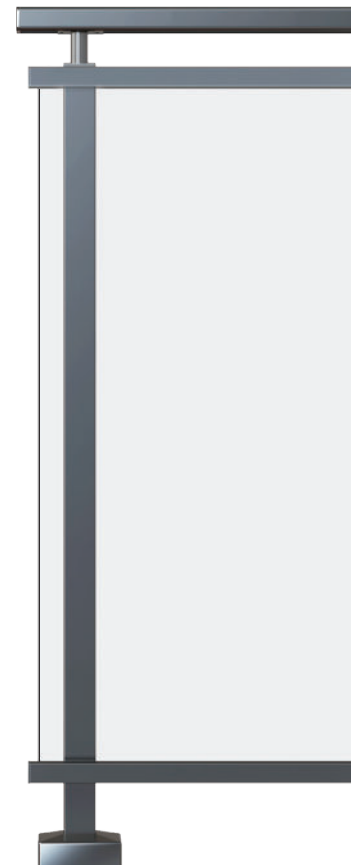
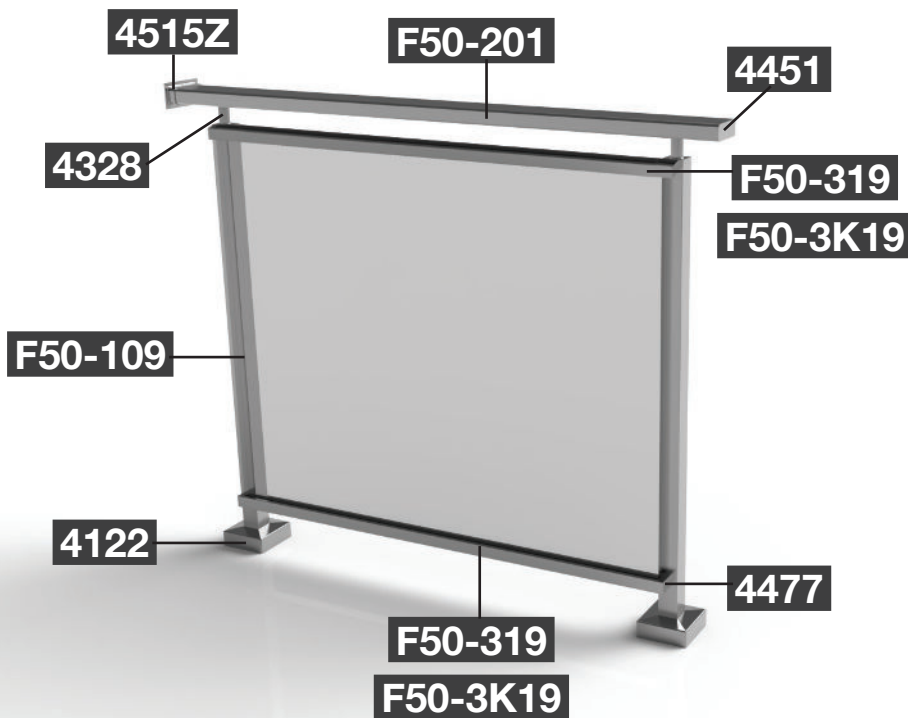



Colonna 40x40
Support column 40x40

Codice / Code	F50-102
Lunghezza / Length	5,8 m

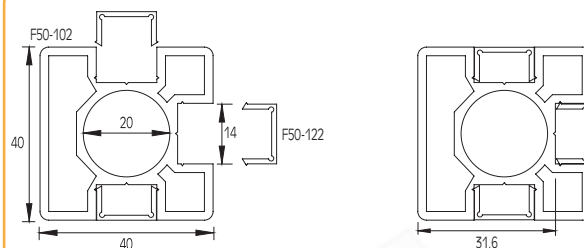

Cover per colonna F50-102
Cover for F50-102 column

Codice / Code	F50-122
Lunghezza / Length	5,8 m

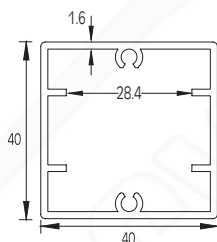

Colonna 40x40
Support column 40x40

Codice / Code	F50-106
Lunghezza / Length	5,8 m

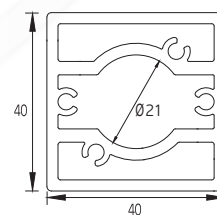

Colonna 40x40
Support column 40x40

Codice / Code	LAB-001
Lunghezza / Length	6,5 m

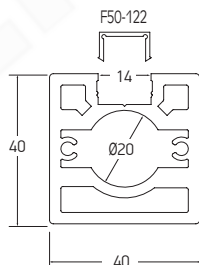

Colonna 40x40 (senza cover)
Support column 40x40 (without cap)

Codice / Code	F50-109
Lunghezza / Length	5,8 m

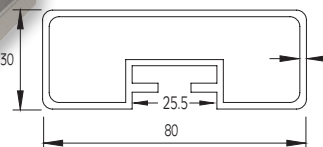

Corrimano 30x80
Handrail 30x80

Codice / Code	F50-201
Lunghezza / Length	5,8 m



Base Corrimano divisibile 30x80
Handrail 30x80 (dividable)

Codice / Code	F50-203
Lunghezza / Length	5,8 m

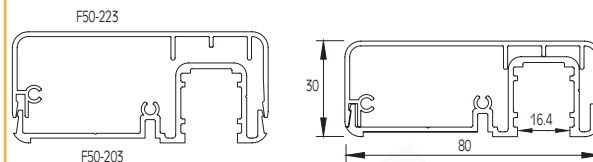

Cover per corrimano divisibile F50-203
Cover for dividable handrail F50-203

Codice / Code	F50-223
Lunghezza / Length	5,8 m



Guida per vetro 10-12mm
Guide for glass 10-12mm

Codice / Code	F50-319
Lunghezza / Length	5,8 m

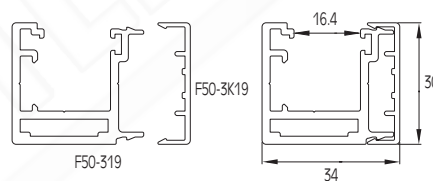

Cover per guida F50-319
Cover for guide F50-319

Codice / Code	F50-3K19
Lunghezza / Length	5,8 m

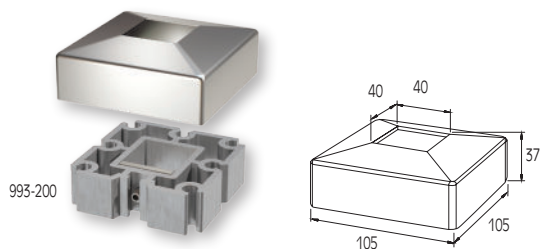

Piede per colonna 40x40
Support foot for 40x40 column

Codice / Code **4122**

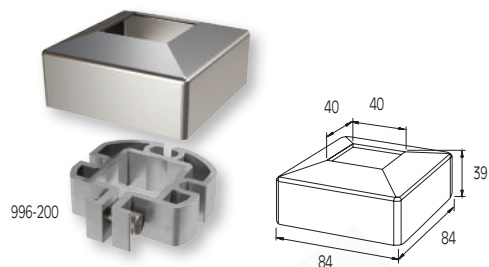

Piede per colonna 40x40
Support foot for 40x40 column

Codice / Code **4124**

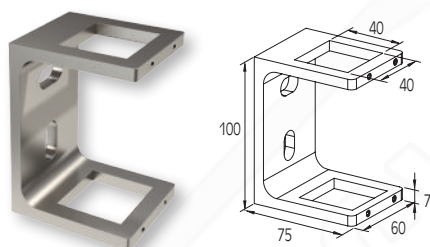

Supporto per fissaggio frontale per colonna 40x40
External support for 40x40 column

Codice / Code **4139**

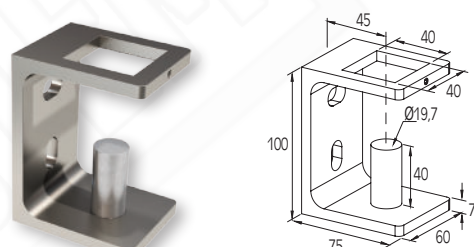

Supporto per fissaggio frontale per colonna F50-102
External support for F50-102 column

Codice / Code **4144**

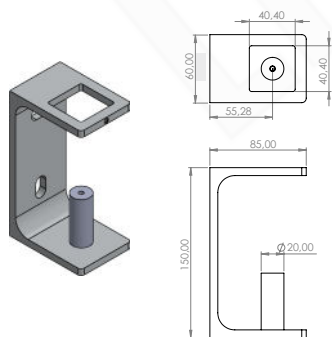

Supporto per fissaggio frontale per
colonna F50-102
External support for F50-102 column

Codice / Code **4144-A**

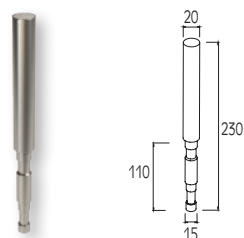

Supporto a pavimento per colonna
F50-102
Infloor support for F50-102 column

Codice / Code **4188**



Supporto a pavimento per colonna F50-
102 (400mm)
Infloor support for F50-102 column

Codice / Code **4188-A**

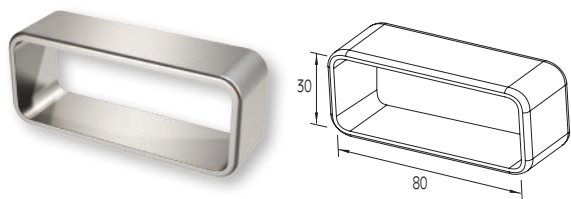

Connettore per corrimano 80x30 dritto
Connector for 80x30 handrails straight

Codice / Code **4249**

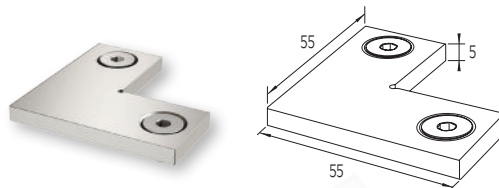

Connettore 90° per corrimano F50-201
Connector 90° for F50-201 handrail

Codice / Code **4250**

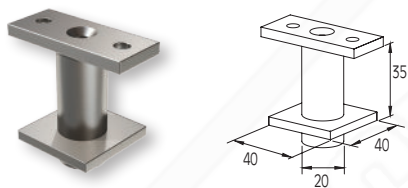

Connettore colonna F50-102 con corrimano F50-201
Support for F50-102 column with F50-201 handrail

Codice / Code **4328**

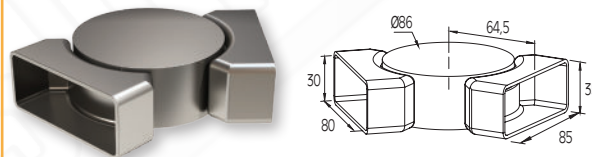

Collegamento ad angolo variabile per corrimano F50-201/203
Adjustable corner connector for F50-201/203 railtop

Codice / Code **4332**

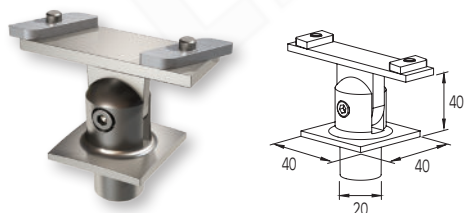

Connettore del corrimano F50-201 con colonna F50-102
Connector for F50-102 column with F50-201 handrail

Codice / Code **4345**

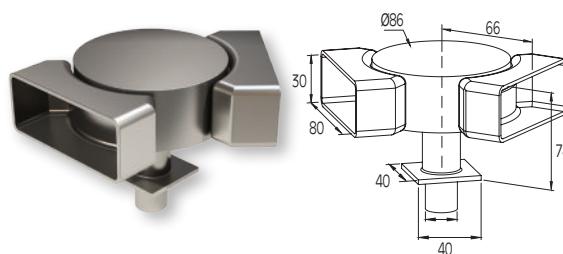

Connettore ad angolo regolabile per corrimano 80x30 con colonna F50-102
Adjustable corner connector for 80x30 handrail with F50-102 column

Codice / Code **4357**

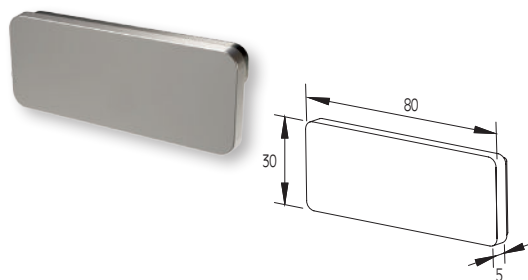

Coperchio per corrimano F50-201
End cap for F50-201 handrail

Codice / Code **4447**

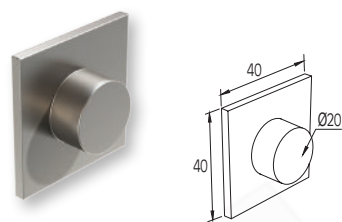

Coperchio per colonna F50-102
End cap for F50-102 column

Codice / Code **4448**

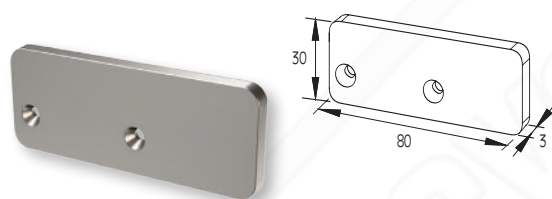

Coperchio per corrimano F50-203
End cap for F50-203 handrail

Codice / Code **4451**

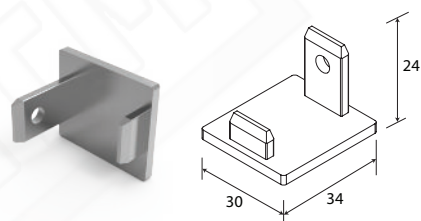

Coperchio per guida F50-319
End cap for F50-319 guide

Codice / Code **4477**

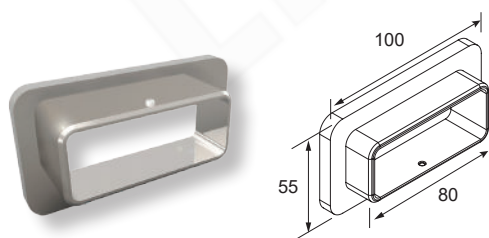

Cover a parete per corrimano F50-201/203
Wall cover for F50-201/203 handrail

Codice / Code **4515Z**

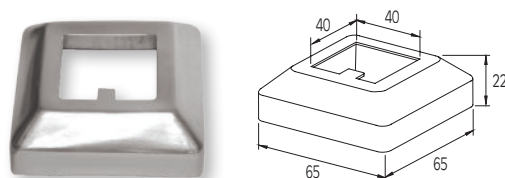

Cover a pavimento per colonna F50-102
Wall cover for F50-102 column

Codice / Code **4514**

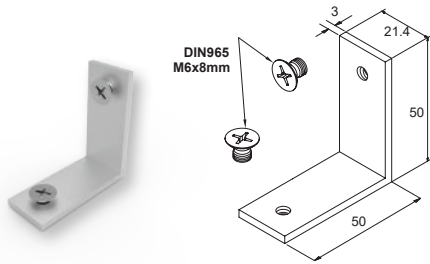

Angolo per guida F50-319
Connector for F50-319 guide

Codice / Code **4259**

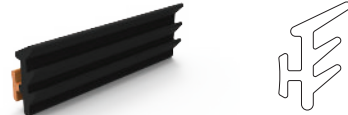

Guarnizione per guida F50-319 (Vetro da 10 mm)
Gasket for F50-319 guide (10 mm glass)

Codice / Code **4912**

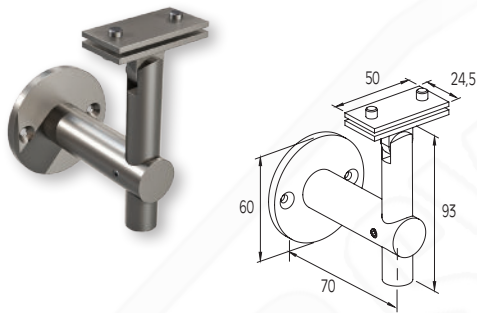

Supporto a parete F50-201
F50-201 Raitop wall support

Codice / Code **F85-452**



- In proporzione 1:1
- Tempo di azione 7-8 minuti
- Tempo di inizio incollaggio 15-18 minuti
- Tempo di completo incollaggio 3-6 ore
- In proportion 1:1
- Working time 7-8 min
- Initial welding time 15-18 min
- Complete welding time 3-6 hours

Collante bicomponente 50 ml
Glue 50 ml

Codice / Code **6K9450**



Beccuccio mixer per collante bicomponente
Glue mixer accessory

Codice / Code **6KA100**



Pistola per applicazione colla bicomponente
Glue application pistol

Codice / Code **6KA200**

