



DeFence

Cancelli

Migliora la sicurezza e lo stile della tua casa con la nostra vasta gamma di cancelli e recinzioni. Disponibile in un'ampia scelta di modelli e colori, i nostri cancelli e le nostre recinzioni non richiedono praticamente alcuna manutenzione, non arrugginiranno né marciranno come l'acciaio o il legno! Che si opti per un cancello classico o per uno contemporaneo, essi manterranno la loro estetica invariata nel tempo: resistenti alle intemperie nelle zone costiere grazie alla loro verniciatura in polveri epossidiche e accessori di alta qualità.

Per la serie *DeFence* è possibile scegliere l'orientamento delle doghe: in questo caso sono state adottate doghe in alluminio a montaggio orizzontale. Disponibile in una vasta gamma di modelli e colori, anche effetto legno.





Leggero, manuale o automatizzato, il cancello in alluminio offre il grande vantaggio di una maggiore durata, con ridotta usura di tutti i suoi componenti, senza compromettere la sicurezza! Sono disponibili cancelli e recinzioni in molte configurazioni, cancello principale, battente o scorrevole e cancello pedonale.

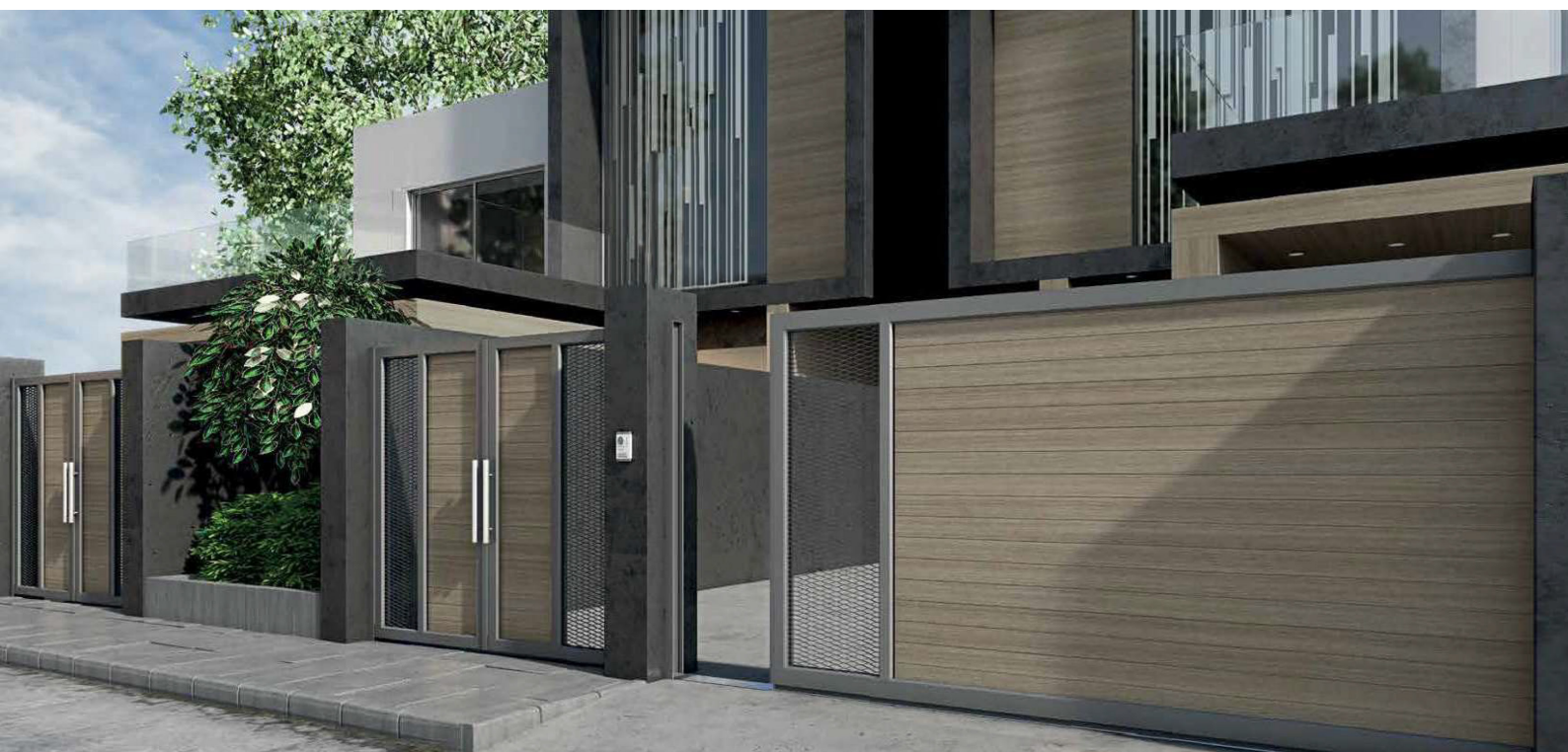

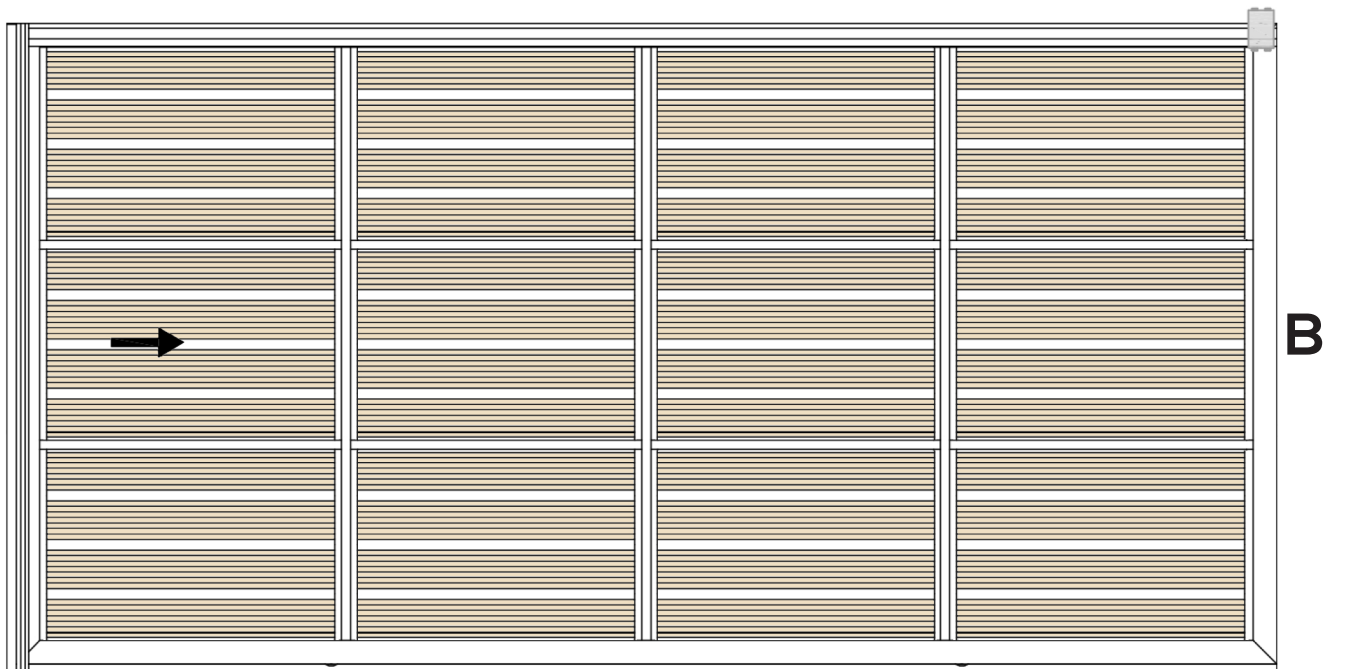
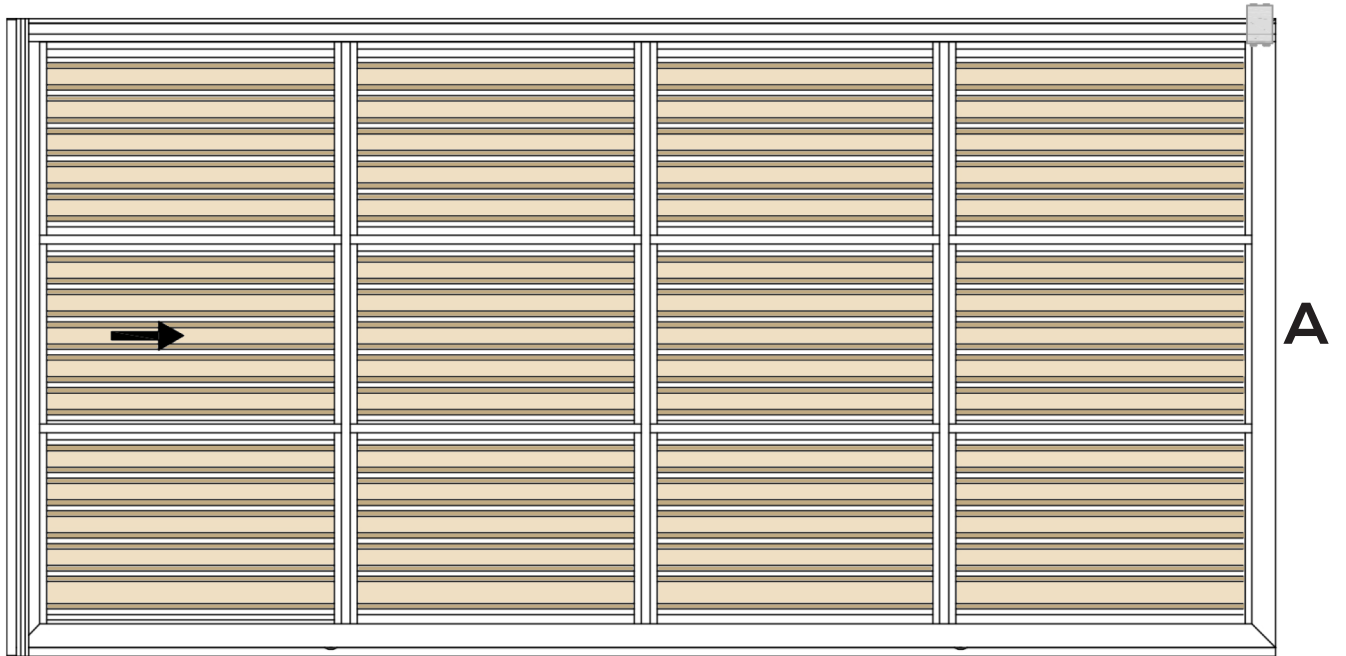

Sezione cancello scorrevole con dettaglio del cancello

Sliding gate section with roller detail

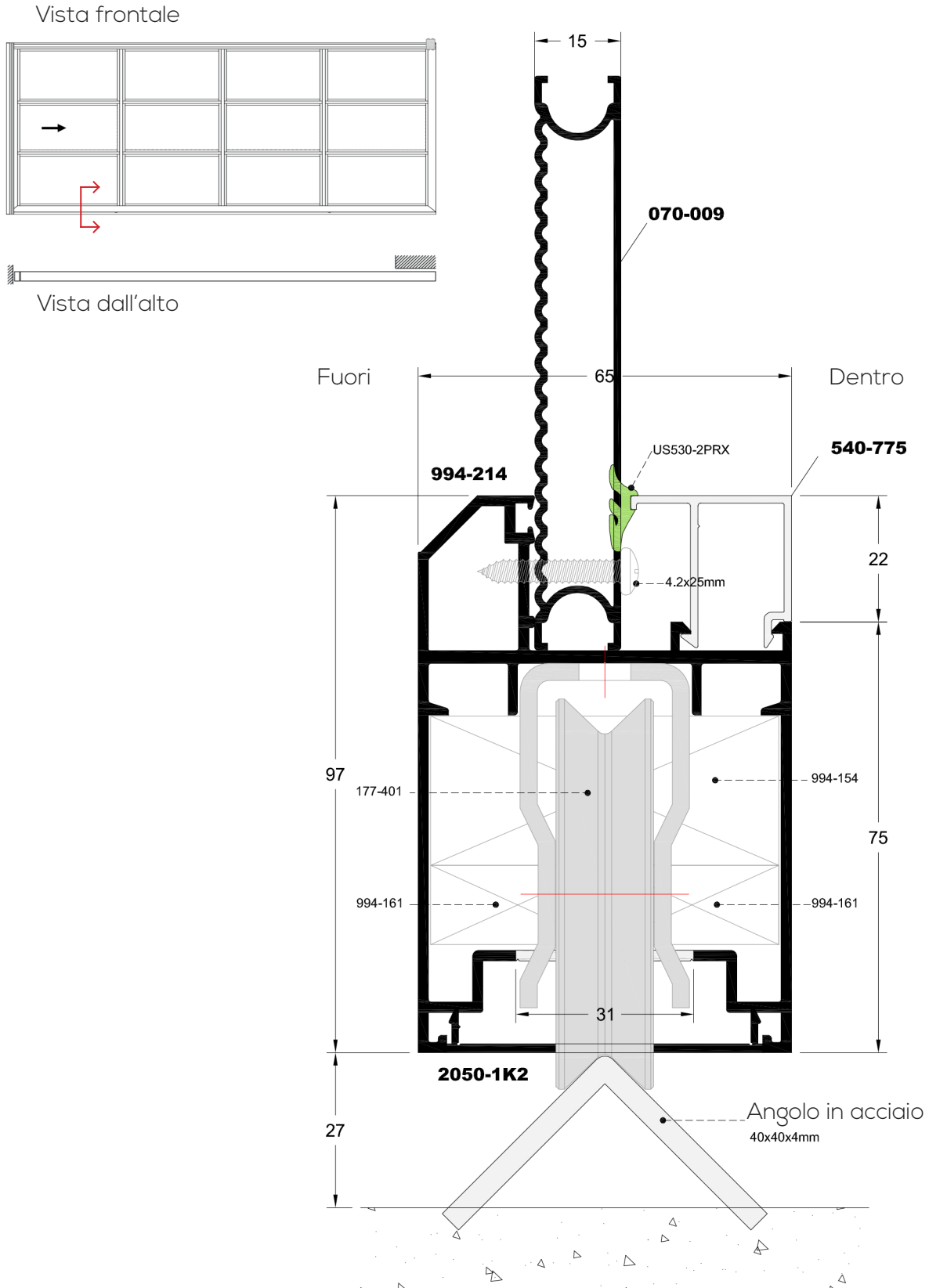

Sezione cancello scorrevole con dettaglio del telaio di battuta fissato a muro

Sliding gate section with detail of the stop frame fixed to the wall

Vista frontale

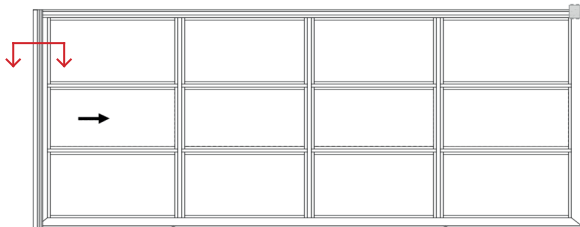

Vista dall'alto

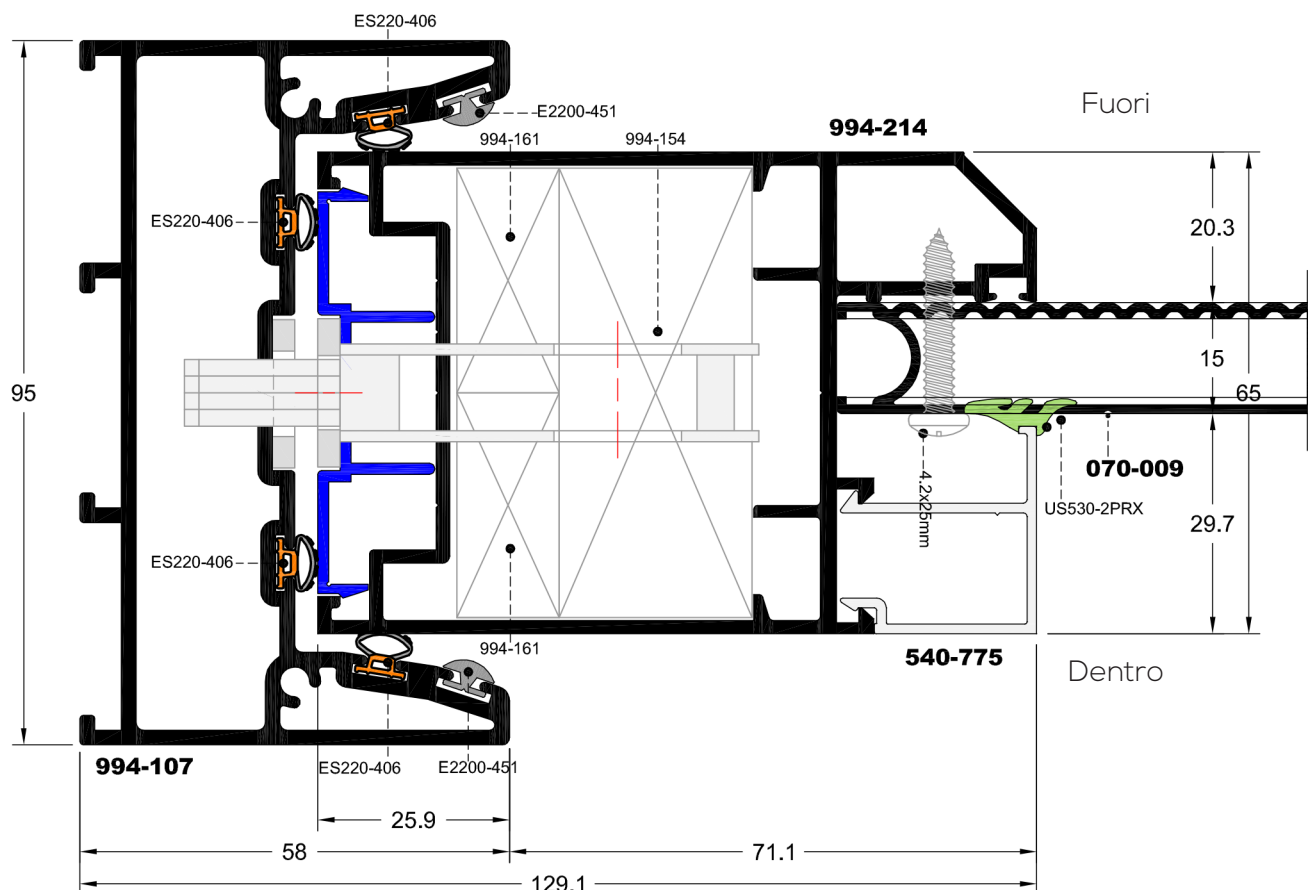

Sezione cancello scorrevole con dettaglio profilo a T

Sliding gate section with T-profile detail

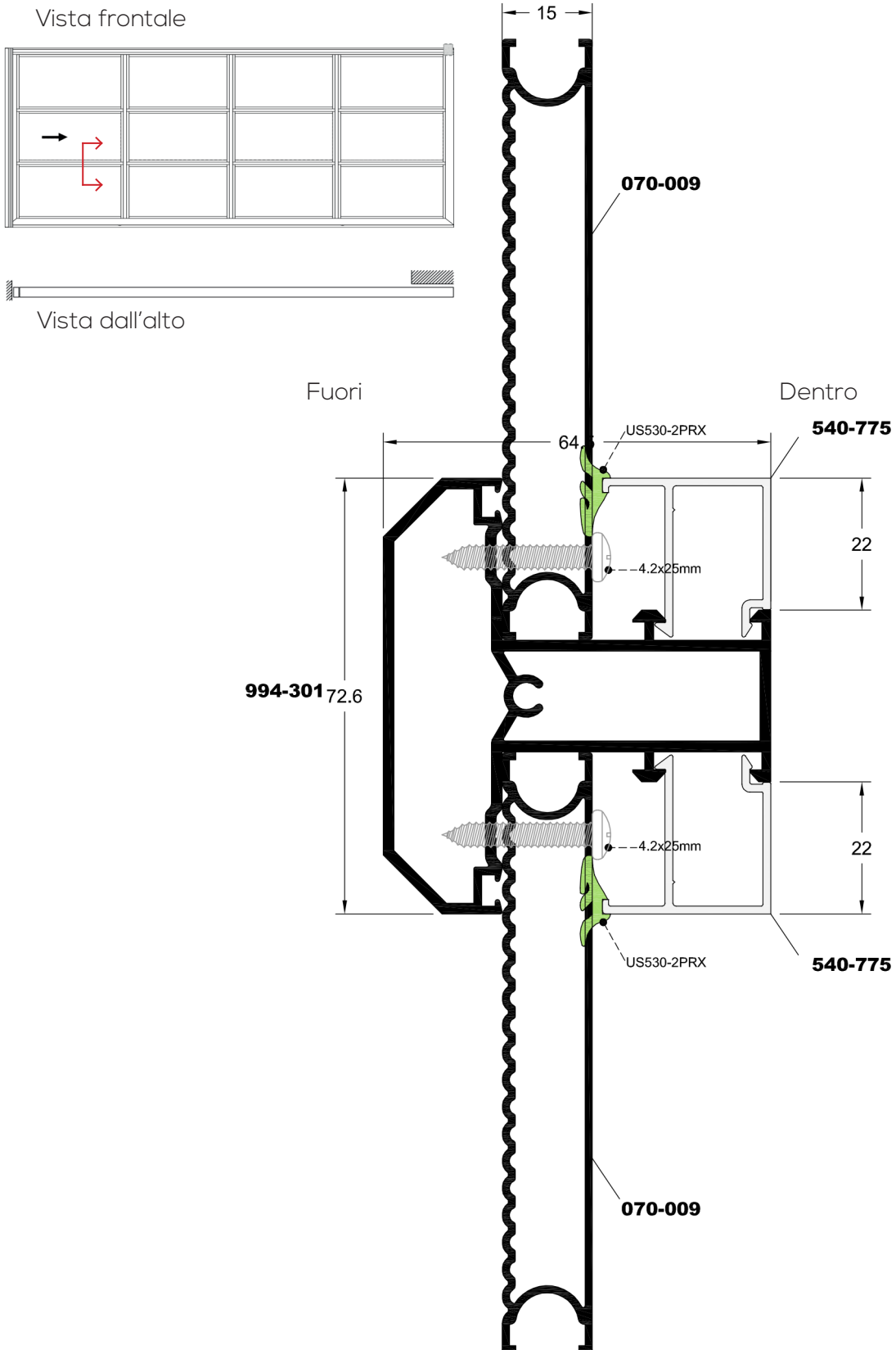

Sezione del cancello scorrevole con dettaglio del supporto superiore fissato a muro

Section of the sliding gate with detail of the upper support fixed to the wall

Vista frontale

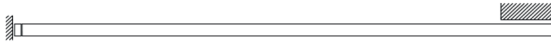
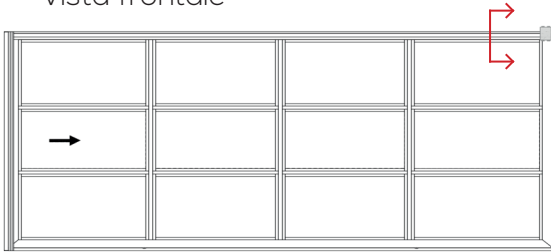

Vista dall'alto

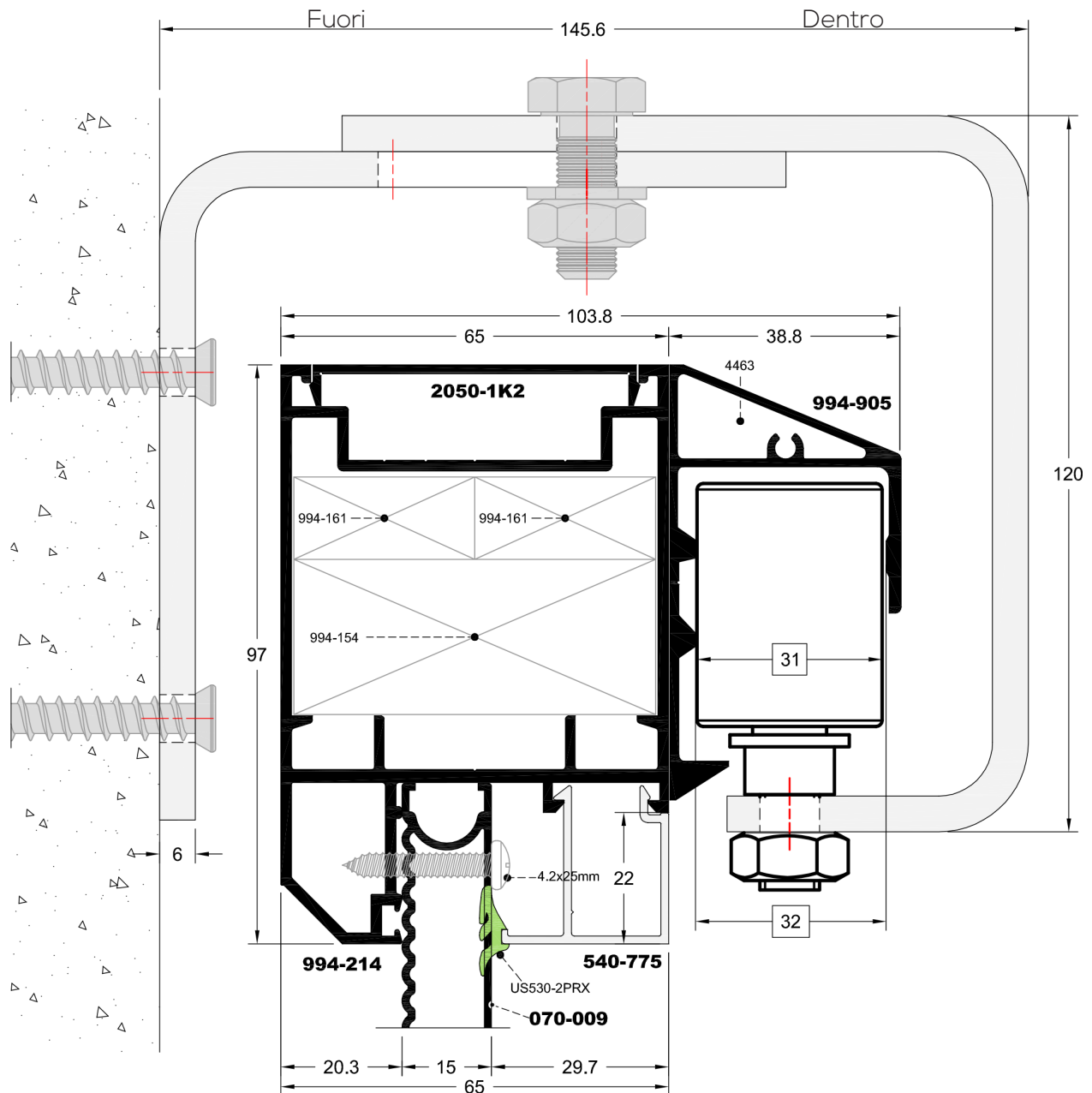

Sezione del profilo anta cancello scorrevole

Section of the sliding gate sash profile

Vista frontale

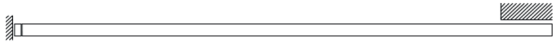
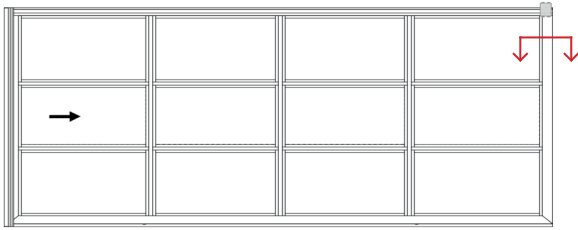

Vista dall'alto

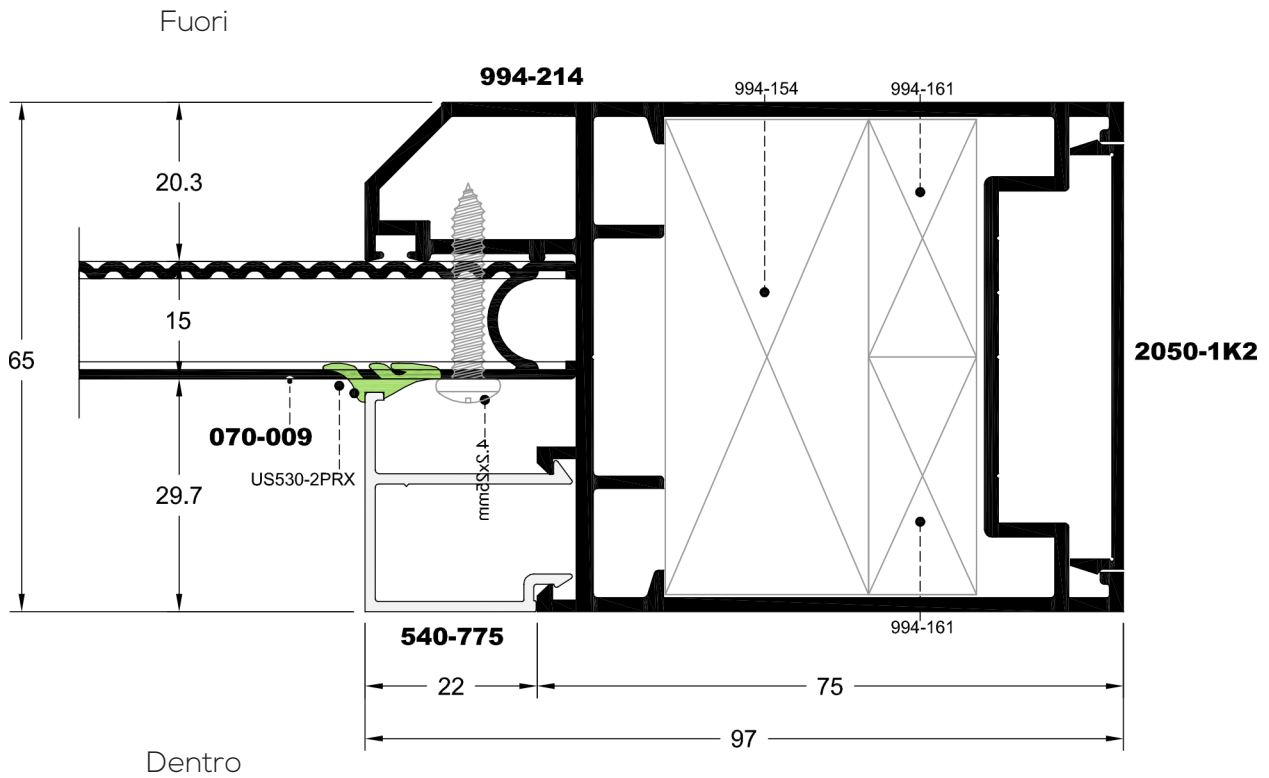

Sezione dell'anta con profilo

Section of sash with grooved profile

Vista frontale

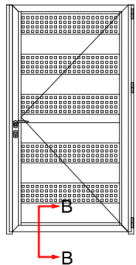

Vista dall'alto

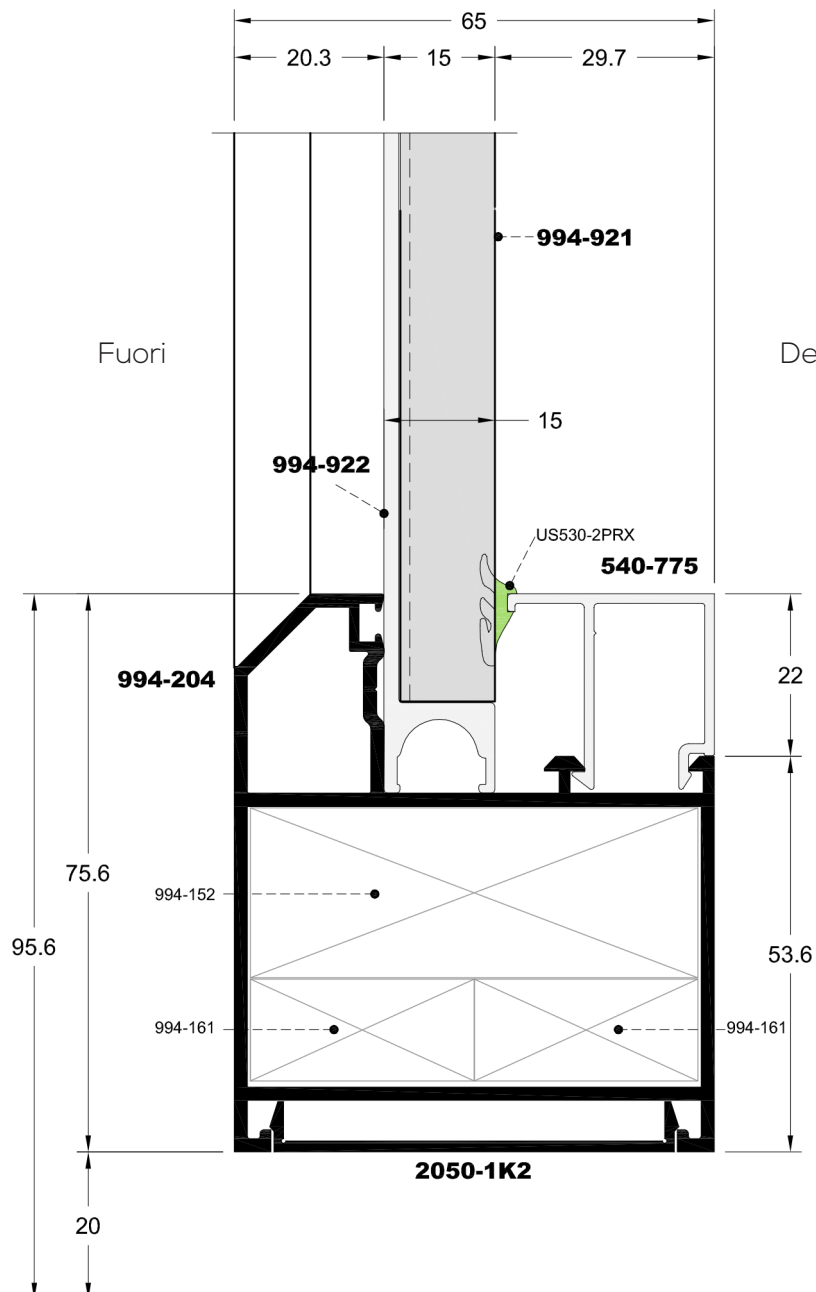
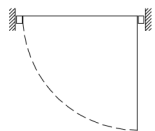

Sezione con dettaglio battuta anta-telaio

Section with sash-frame join detail

Vista frontale

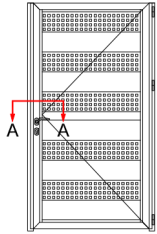

Vista dall'alto

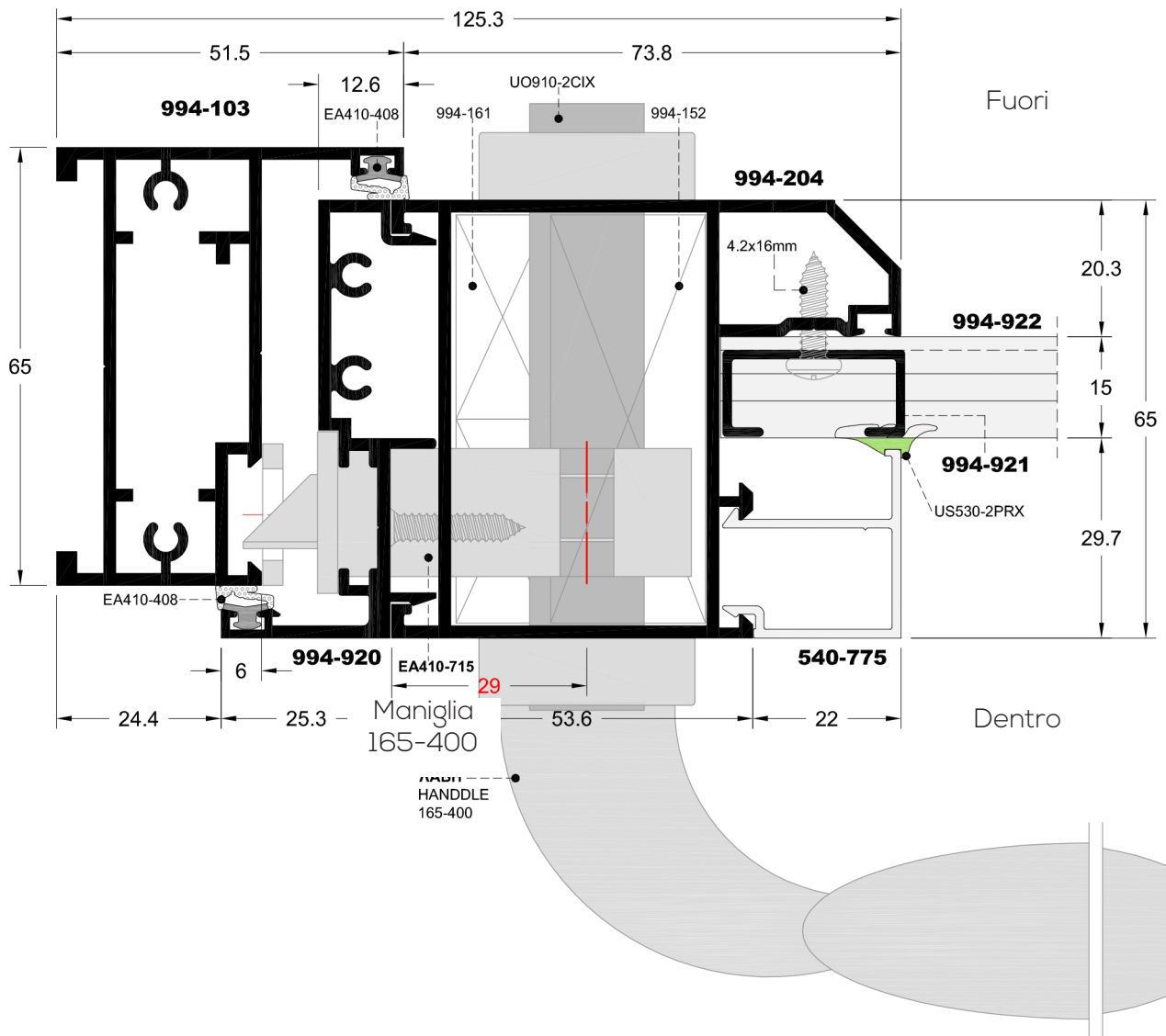
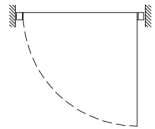

Sezione superiore dell'anta

Section of upper sash

Vista frontale

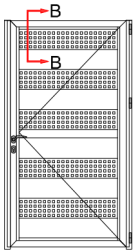

Vista dall'alto

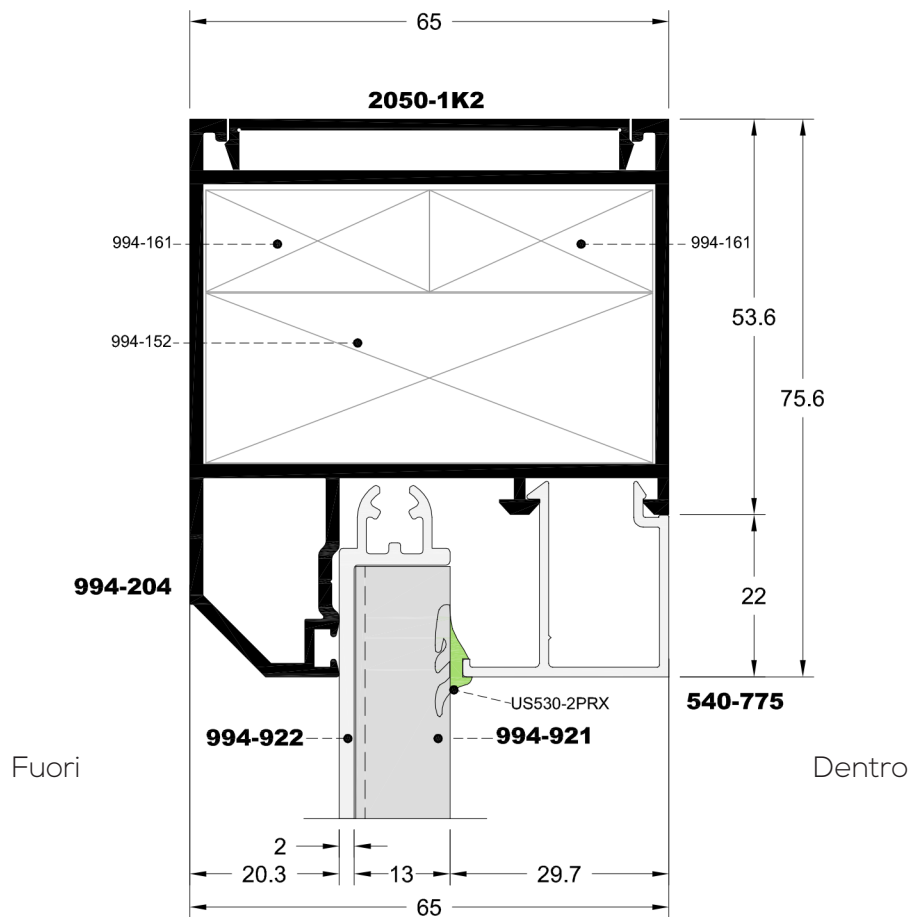
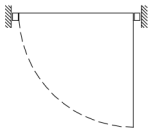

Sezione del nodo centrale Section of central join

Vista frontale

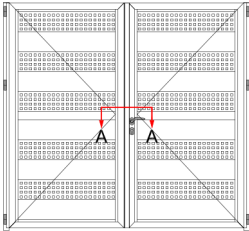

Vista dall'alto

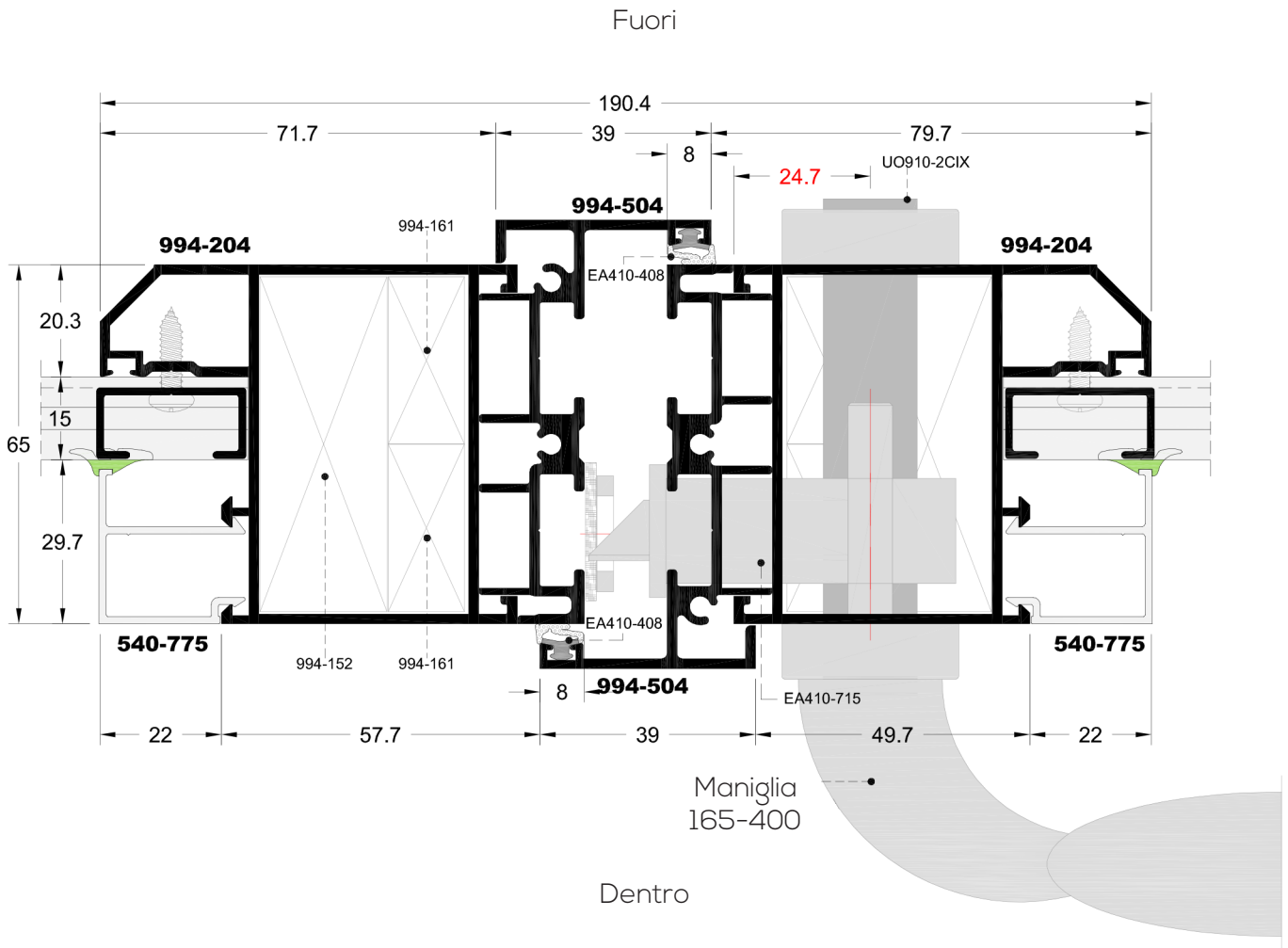
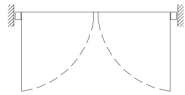

Sezione con dettaglio del profilo a T Section with T-profile detail

Vista frontale

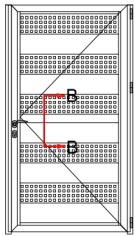

Vista dall'alto

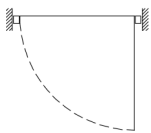

Fuori

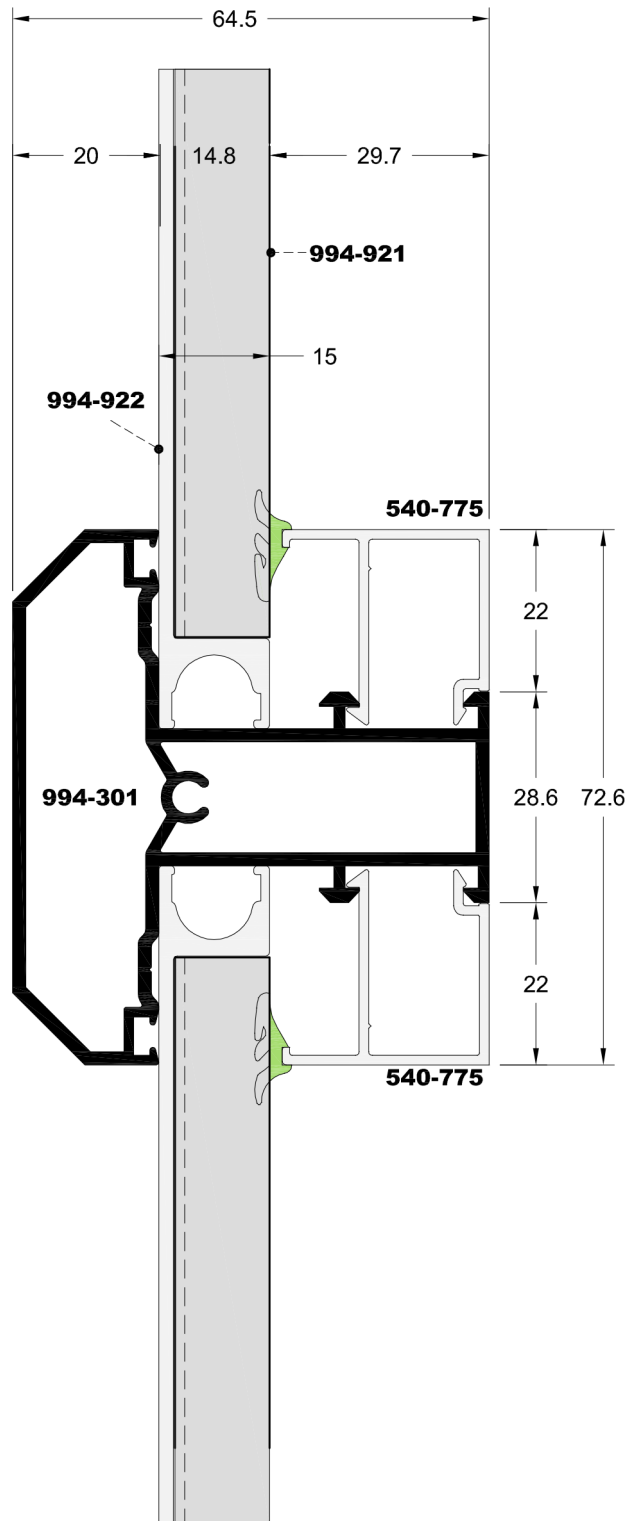

Dentro

Lavorazione su anta per installazione squadretta angolare

Machining on sash for installation of corner join

Per ante: **994-204, 994-214**

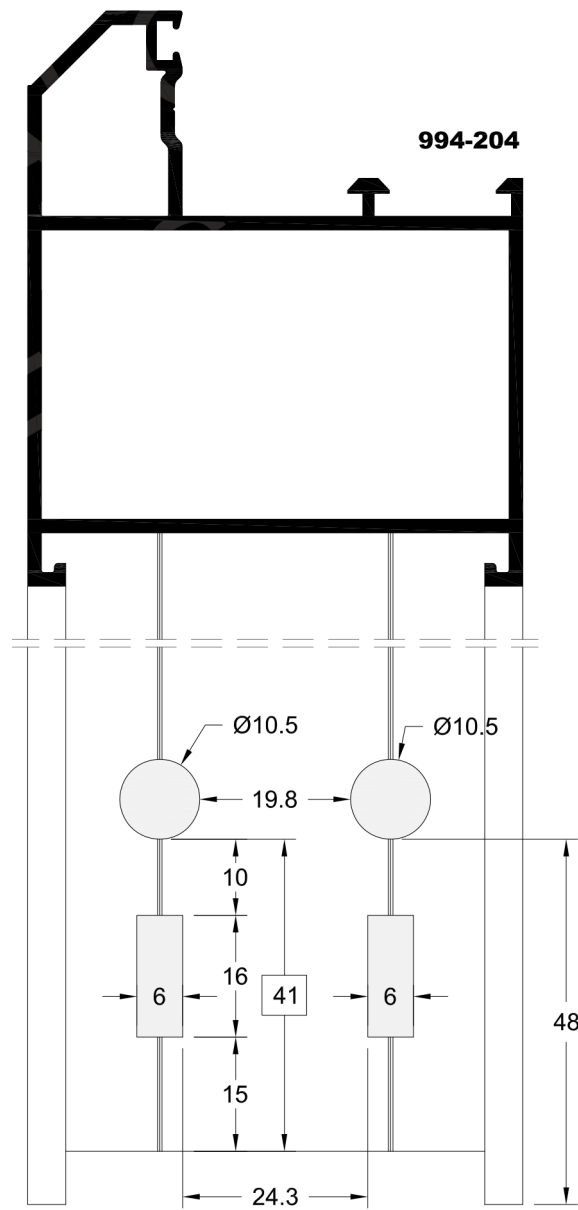

Lavorazione foro per serratura e maniglia

Working perforating for lock and handle

N.B. la lavorazione è differente per serrature non di serie

Per ante: **994-204**

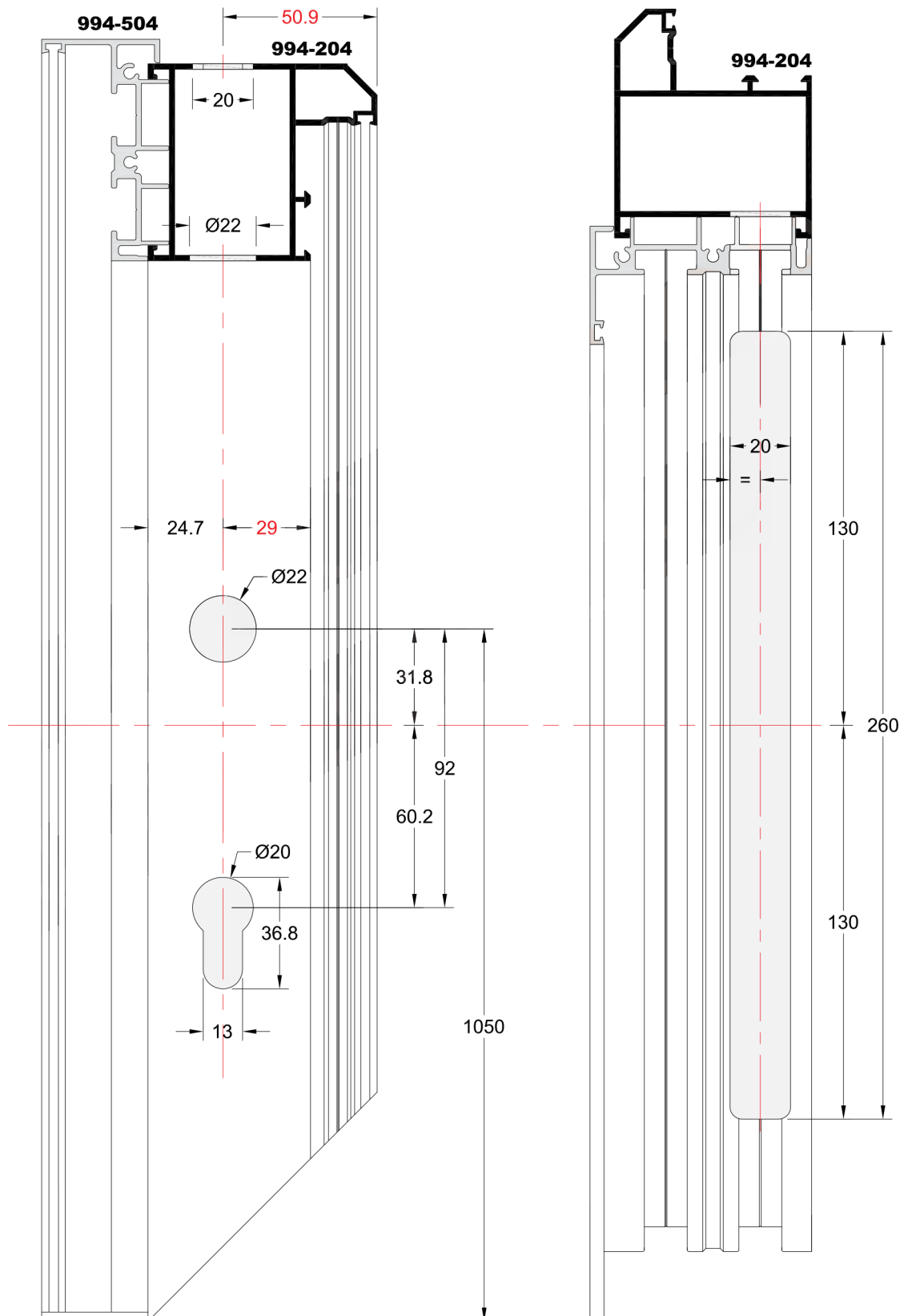

Lavorazione su profilo a T con fresa

Machining on T profile with milling tool

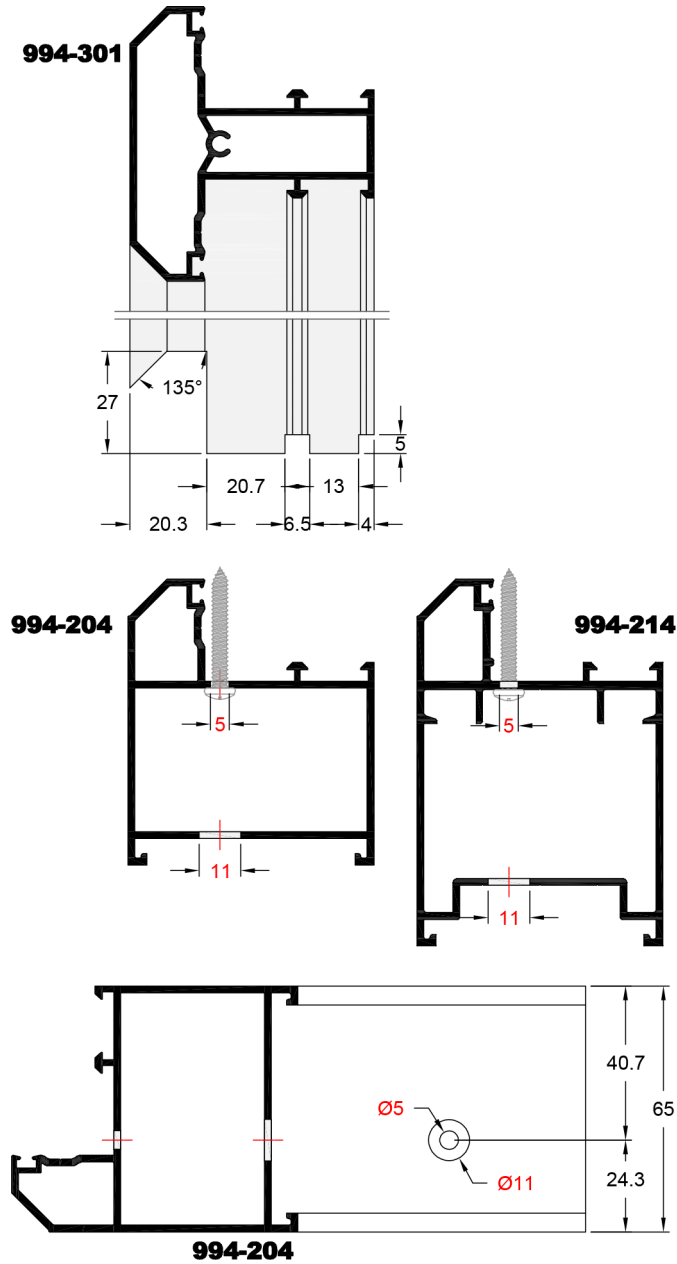

Strumento di fresatura
EA010.71SDU0100000

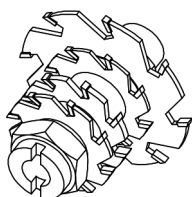

Profili di lavoro con traversa 994-301:

- Anta **994-204, 994-214**
- Traversa **994-301**

Connessione tra traversa e anta

Transom connection with sash

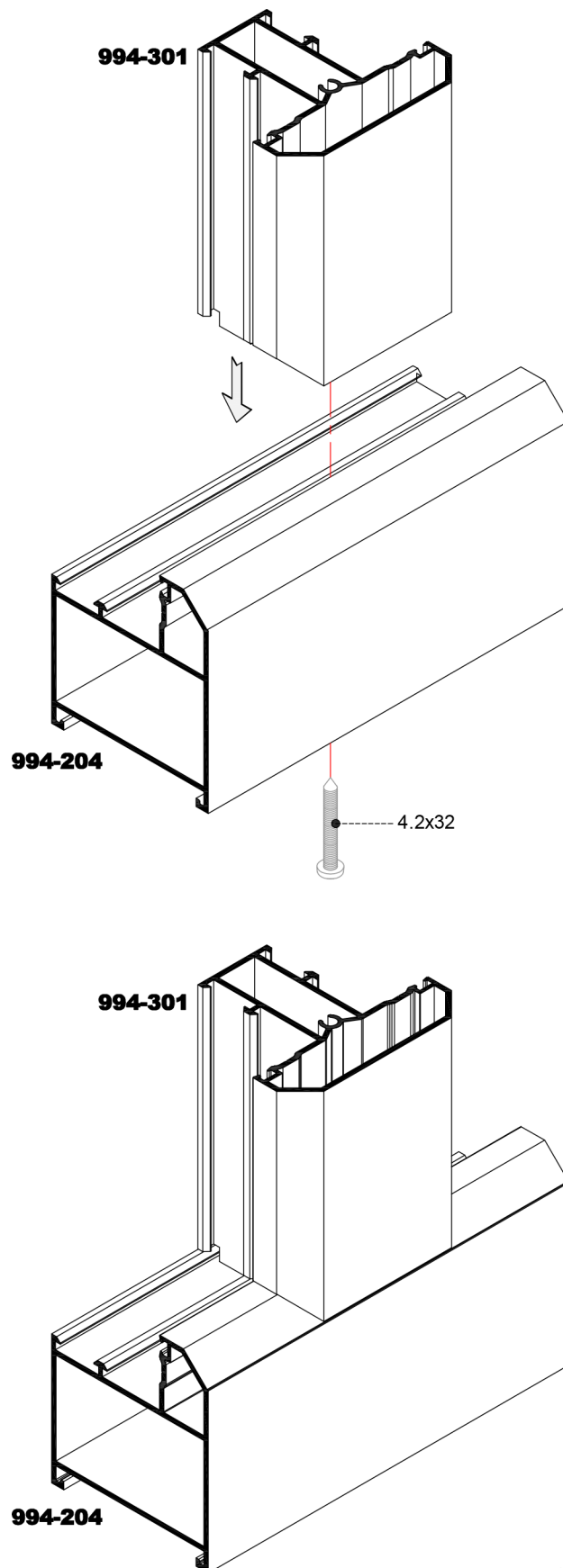

Calcoli di taglio per cancello battente

Cutting calculations for gate

Per ante:

994-204, 994-206, 994-207

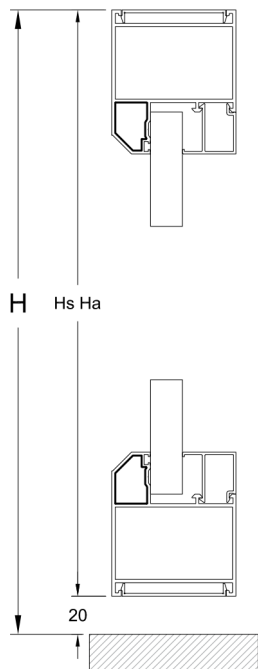

Anta:

$$H_s = H - 20 \text{ mm}$$

$$H_a = H_s$$

$$L_s = L - 99.4 \text{ mm}$$

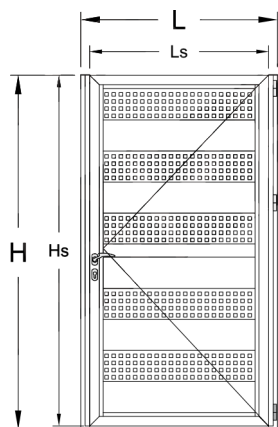

H = altezza della costruzione

L = larghezza della costruzione

Hs = altezza dell'anta

Ls = larghezza dell'anta

Ha = altezza del profilo aggiuntivo

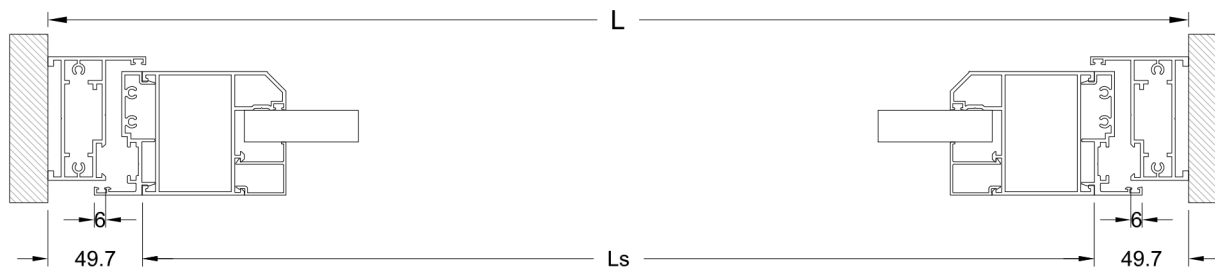

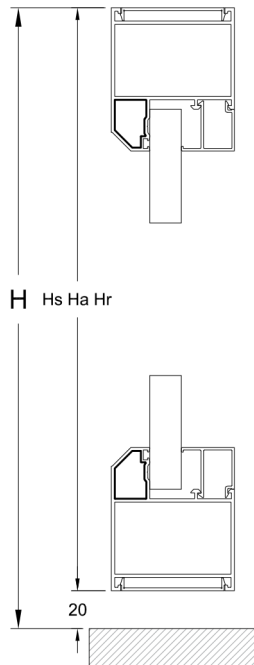

Anta:
 $H_s = H - 20 \text{ mm}$
 $H_a = H_s$
 $H_r = H_s$
 $L_s = L - 138.6 \text{ mm}$

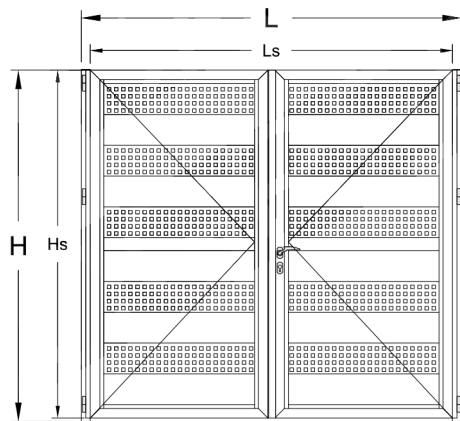

H = altezza della costruzione
 L = larghezza della costruzione
 H_s = altezza dell'anta
 L_s = larghezza dell'anta
 H_a = altezza del profilo addizionale
 H_r = altezza del profilo di battuta

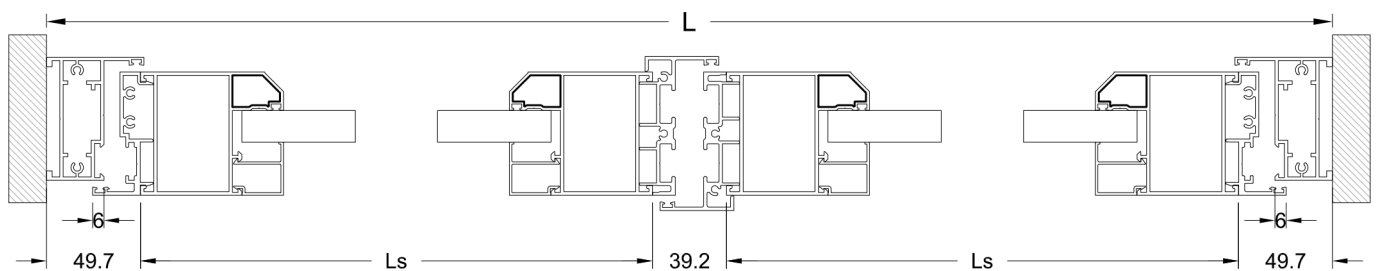

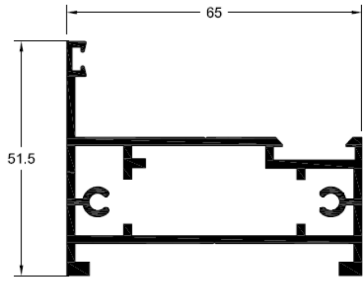

Telaio cancello battente
Frame for door fence

Codice / Code **994-103**

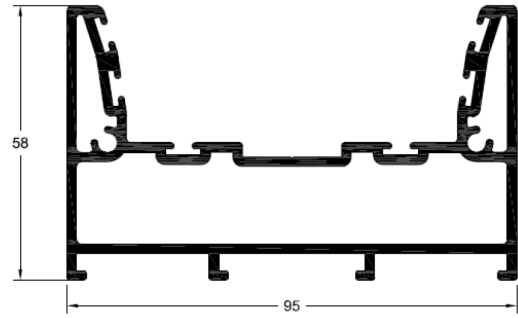

Telaio per cancello scorrevole
Frame for sliding gate

Codice / Code **994-107**

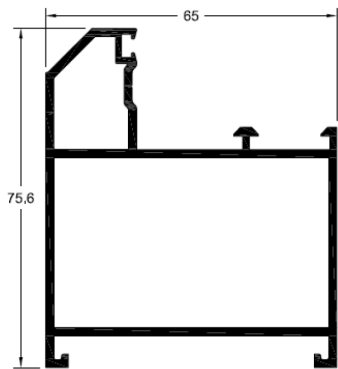

Anta cancello battente
Swing gate frame

Codice / Code **994-204**

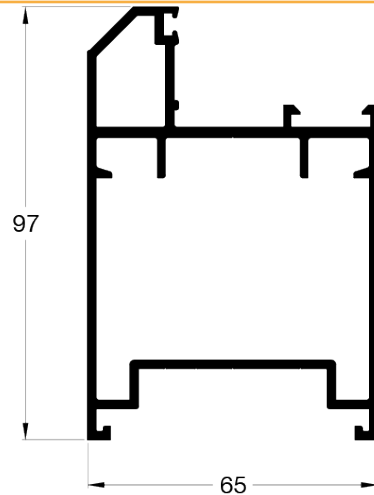

Anta cancello scorrevole
Sliding gate frame

Codice / Code **994-214**

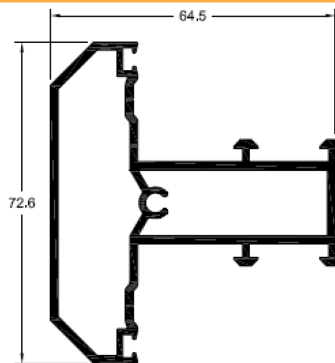

Traverso a T
Transom for door fence

Codice / Code **994-301**

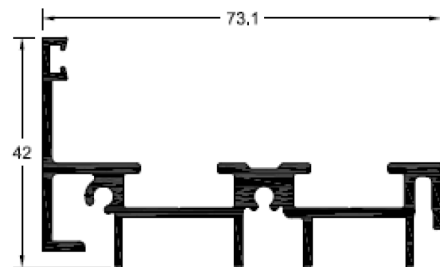

Adattatore nodo centrale
Adapter

Codice / Code **994-504**

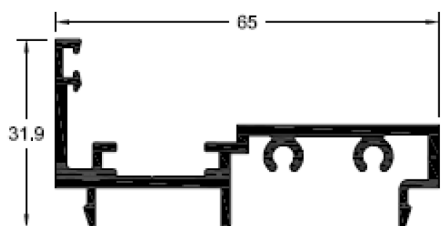

Profilo aggiuntivo anta - telaio
Additional profile

Codice / Code **994-920**

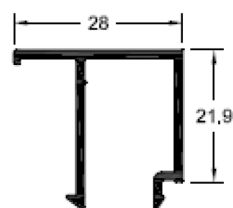

Fermavetro
Bead

Codice / Code **540-775**

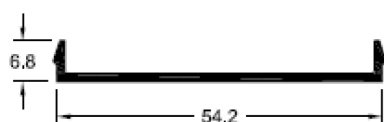

Cover anta
Cover profile

Codice / Code **2050-1K2**

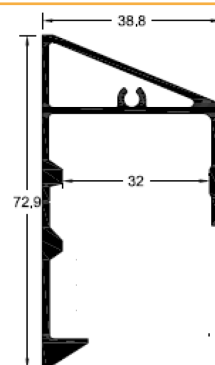

Guida scorrevole
Roller rail

Codice / Code **994-905**

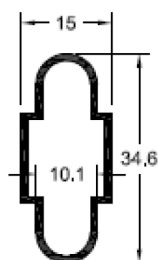

Ovalina s. 15 mm
Connector grooved profile

Codice / Code **070-019**

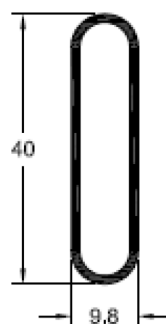

Ovalina s. 9.8 mm
Oval

Codice / Code **510-918**

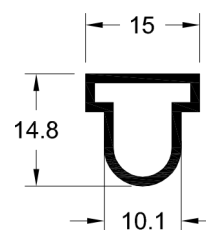

Cover per doga
Cover for grooved profile

Codice / Code **070-0K9**



Doga
Grooved profile

Codice / Code

070-005

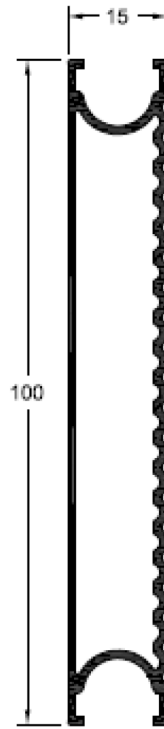

Doga
Grooved profile

Codice / Code

070-009

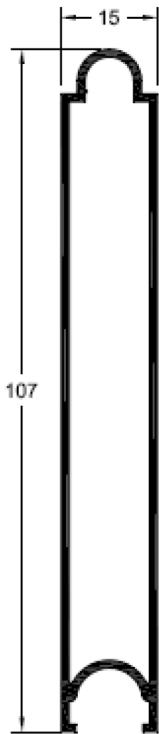

Doga
Grooved profile

Codice / Code

070-022

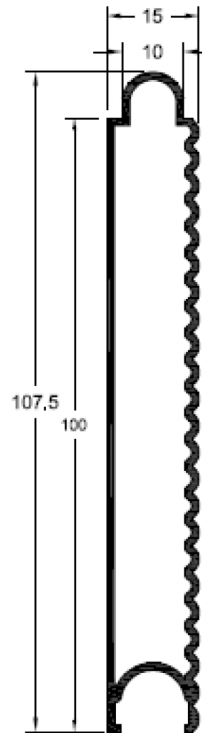

Doga
Grooved profile

Codice / Code

070-011

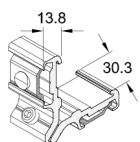

Squadretta angolare 30.3x13.8 mm
Corner joint 30.3x13.8 mm

Codice / Code **994-161**

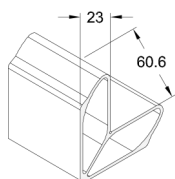

Squadretta 60.6x23 mm
Corner joint 60.6x23 mm

Codice / Code **994-152**

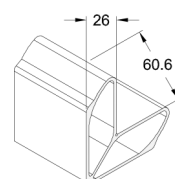

Squadretta 60.6x26 mm
Corner joint 60.6x26 mm

Codice / Code **994-154**

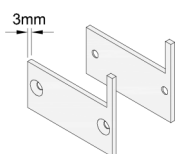

Tappo terminale per telaio 994-103
End cap for frame 994-103

Codice / Code **4474**

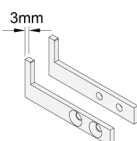

Tappo terminale per profilo aggiuntivo
994-920
End cap for additional profile
994-920

Codice / Code **4475**

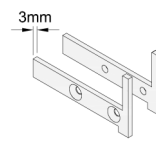

Tappo terminale per profilo 994-504
End cap for rebate profile 994-504

Codice / Code **4476**

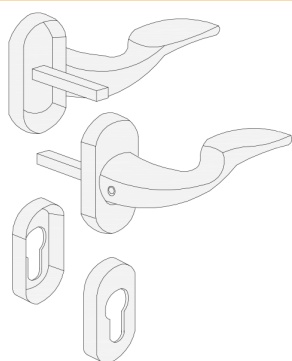

Maniglia inox (coppia)
Handle inox (pair)

Codice / Code **165-400**

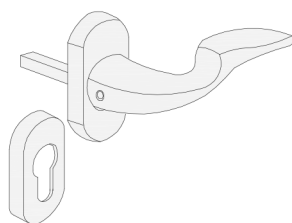

Maniglia inox (pezzo)
Handle inox (piece)

Codice / Code **165-401L**
165-401R

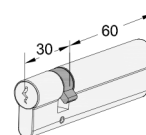

Cilindro 90 mm (30+60)
Cylinder 90 mm (30+60)

Codice / Code **U0910-2CIX**

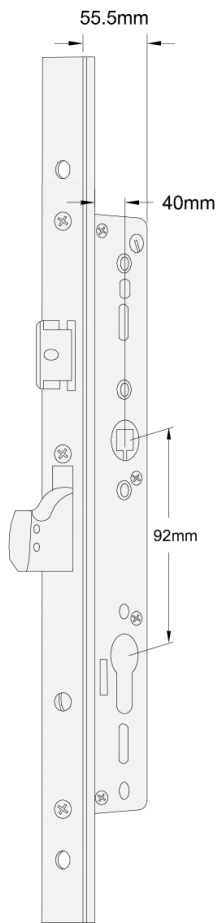

Serratura 40 mm
Locking 40 mm

Codice / Code **EA410-715**

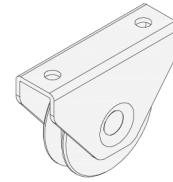

Carrello per porta scorrevole Ø70
Roller for sliding door Ø70

Codice / Code **177-401**

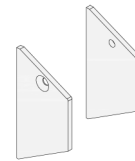

Tappo terminale per profilo 994-905
End cap for profile 994-905

Codice / Code **4463**

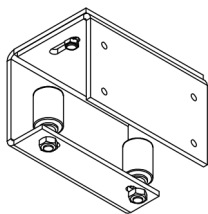

Supporto a parete per cancello scorrevole
Roller system for sliding gate

Codice / Code **4145**



Cerniera per 994-103
Connector for 994-103

Codice / Code **EA510-141**